

STANDARD EUROPEAN PROFILE CYLINDER

101C (5990) RANGE SHORT CAM

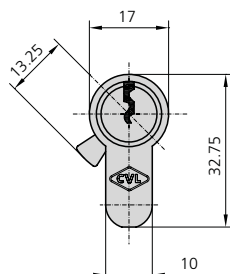

CHARACTERISTIC

- Brass and nickel finishings available
- Cylinder body and rotor in brass
- Pins in stainless steel
- 13,5 mm short cam
- Brass and nickel finishings available
- 3 keys
- Dimensions from 40 to 160mm

OPTIONAL ACCESSORIES

| DESCRIPTION | REF. | MEASUREMENTS | | | FINISH | UNITS |
|-------------------|------------|--------------|----|-----|--------|-------|
| | | A | B | C | | |
| • Double cylinder | 101C3030/3 | 31 | 31 | 62 | LP | 1 |
| | 101C3030/4 | 31 | 31 | 62 | LN | 1 |
| | 101C3035/3 | 31 | 36 | 67 | LP | 1 |
| | 101C3035/4 | 31 | 36 | 67 | LN | 1 |
| | 101C3040/3 | 31 | 41 | 72 | LP | 1 |
| | 101C3040/4 | 31 | 41 | 72 | LN | 1 |
| | 101C3535/3 | 36 | 36 | 72 | LP | 1 |
| | 101C3535/4 | 36 | 36 | 72 | LN | 1 |
| | 101C3045/3 | 31 | 46 | 77 | LP | 1 |
| | 101C3045/4 | 31 | 46 | 77 | LN | 1 |
| | 101C3540/3 | 36 | 41 | 77 | LP | 1 |
| | 101C3540/4 | 36 | 41 | 77 | LN | 1 |
| | 101C3050/3 | 31 | 51 | 82 | LP | 1 |
| | 101C3050/4 | 31 | 51 | 82 | LN | 1 |
| | 101C3545/3 | 36 | 46 | 82 | LP | 1 |
| | 101C3545/4 | 36 | 46 | 82 | LN | 1 |
| | 101C4040/3 | 41 | 41 | 82 | LP | 1 |
| | 101C4040/4 | 41 | 41 | 82 | LN | 1 |
| | 101C3055/3 | 31 | 56 | 87 | LP | 1 |
| | 101C3055/4 | 31 | 56 | 87 | LN | 1 |
| | 101C4045/3 | 41 | 46 | 87 | LP | 1 |
| | 101C4045/4 | 41 | 46 | 87 | LN | 1 |
| | 101C3550/3 | 36 | 51 | 87 | LP | 1 |
| | 101C3550/4 | 36 | 51 | 87 | LN | 1 |
| | 101C3060/3 | 31 | 61 | 92 | LP | 1 |
| | 101C3060/4 | 31 | 61 | 92 | LN | 1 |
| | 101C3555/3 | 36 | 56 | 92 | LP | 1 |
| | 101C3555/4 | 36 | 56 | 92 | LN | 1 |
| | 101C4050/3 | 41 | 51 | 92 | LP | 1 |
| | 101C4050/4 | 41 | 51 | 92 | LN | 1 |
| | 101C4545/3 | 46 | 46 | 92 | LP | 1 |
| | 101C4545/4 | 46 | 46 | 92 | LN | 1 |
| | 101C3065/3 | 31 | 66 | 97 | LP | 1 |
| | 101C3065/4 | 31 | 66 | 97 | LN | 1 |
| | 101C3560/3 | 36 | 61 | 97 | LP | 1 |
| | 101C3560/4 | 36 | 61 | 97 | LN | 1 |
| | 101C3070/3 | 31 | 71 | 102 | LP | 1 |
| | 101C3070/4 | 31 | 71 | 102 | LN | 1 |

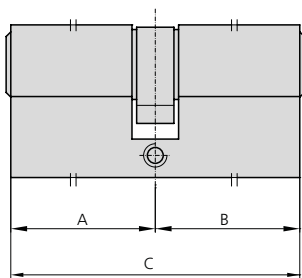

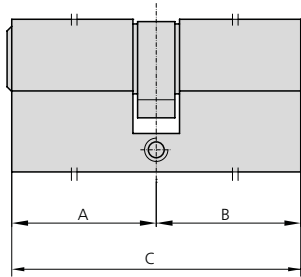
STANDARD EUROPEAN PROFILE CYLINDER
101C (5990) RANGE SHORT CAM

| DESCRIPTION | REF. | MEASUREMENTS | | | FINISH | UNITS |
|-------------|-------------|--------------|-----|-----|--------|-------|
| | | A | B | C | | |
| | 101C3565/3 | 36 | 66 | 102 | LP | 1 |
| | 101C3565/4 | 36 | 66 | 102 | LN | 1 |
| | 101C4060/3 | 41 | 61 | 102 | LP | 1 |
| | 101C4060/4 | 41 | 61 | 102 | LN | 1 |
| | 101C4555/3 | 46 | 56 | 102 | LP | 1 |
| | 101C4555/4 | 46 | 56 | 102 | LN | 1 |
| | 101C5050/3 | 51 | 51 | 102 | LP | 1 |
| | 101C5050/4 | 51 | 51 | 102 | LN | 1 |
| | 101C4560/3 | 46 | 61 | 107 | LP | 1 |
| | 101C4560/4 | 46 | 61 | 107 | LN | 1 |
| | 101C3080/3 | 31 | 81 | 112 | LP | 1 |
| | 101C3080/4 | 31 | 81 | 112 | LN | 1 |
| | 101C4070/3 | 41 | 71 | 112 | LP | 1 |
| | 101C4070/4 | 41 | 71 | 112 | LN | 1 |
| | 101C4565/3 | 46 | 66 | 112 | LP | 1 |
| | 101C4565/4 | 46 | 66 | 112 | LN | 1 |
| | 101C4565/3 | 51 | 61 | 112 | LP | 1 |
| | 101C5060/4 | 51 | 61 | 112 | LN | 1 |
| | 101C5555/3 | 56 | 56 | 112 | LP | 1 |
| | 101C5555/4 | 56 | 56 | 112 | LN | 1 |
| | 101C3090/3 | 31 | 91 | 122 | LP | 1 |
| | 101C3090/4 | 31 | 91 | 122 | LN | 1 |
| | 101C3585/3 | 36 | 86 | 122 | LP | 1 |
| | 101C3585/4 | 36 | 86 | 122 | LN | 1 |
| | 101C4080/3 | 41 | 81 | 122 | LP | 1 |
| | 101C4080/4 | 41 | 81 | 122 | LN | 1 |
| | 101C4575/3 | 46 | 76 | 122 | LP | 1 |
| | 101C4575/4 | 46 | 76 | 122 | LN | 1 |
| | 101C6060/3 | 61 | 61 | 122 | LP | 1 |
| | 101C6060/4 | 61 | 61 | 122 | LN | 1 |
| | 101C30100/3 | 31 | 101 | 132 | LP | 1 |
| | 101C30100/4 | 31 | 101 | 132 | LN | 1 |
| | 101C4585/3 | 46 | 86 | 132 | LP | 1 |
| | 101C4585/4 | 46 | 86 | 132 | LN | 1 |
| | 101C6565/3 | 66 | 66 | 132 | LP | 1 |
| | 101C6565/4 | 66 | 66 | 132 | LN | 1 |
| | 101C40100/3 | 41 | 101 | 142 | LP | 1 |
| | 101C40100/4 | 41 | 101 | 142 | LN | 1 |
| | 101C7070/3 | 71 | 71 | 142 | LP | 1 |
| | 101C7070/4 | 71 | 71 | 142 | LN | 1 |
| | 101C7575/3 | 76 | 76 | 152 | LP | 1 |
| | 101C7575/4 | 76 | 76 | 152 | LN | 1 |
| | 101C8080/3 | 81 | 81 | 162 | LP | 1 |
| | 101C8080/4 | 81 | 81 | 162 | LN | 1 |

STANDARD EUROPEAN PROFILE CYLINDER

101C (5990) RANGE SHORT CAM

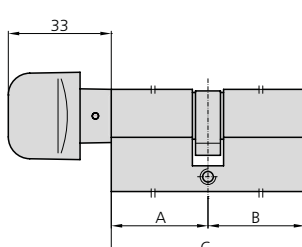
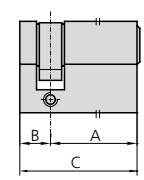
| DESCRIPTION | REF. | MEASUREMENTS | | | FINISH | UNITS |
|--|--------------|--------------|-----|-----|--------|-------|
| | | A | B | C | | |
| <ul style="list-style-type: none"> Cylinder with knob  | 101CPM3030/3 | 31 | 31 | 62 | LP | 1 |
| | 101CPM3030/4 | 31 | 31 | 62 | LN | 1 |
| | 101CPM3035/3 | 31 | 36 | 67 | LP | 1 |
| | 101CPM3035/4 | 31 | 36 | 67 | LN | 1 |
| | 101CPM3040/3 | 31 | 41 | 72 | LP | 1 |
| | 101CPM3040/4 | 31 | 41 | 72 | LN | 1 |
| | 101CPM3535/3 | 36 | 36 | 72 | LP | 1 |
| | 101CPM3535/4 | 36 | 36 | 72 | LN | 1 |
| | 101CPM4030/3 | 41 | 31 | 72 | LP | 1 |
| | 101CPM4030/4 | 41 | 31 | 72 | LN | 1 |
| | 101CPM3045/3 | 31 | 46 | 77 | LP | 1 |
| | 101CPM3045/4 | 31 | 46 | 77 | LN | 1 |
| | 101CPM3050/3 | 31 | 51 | 82 | LP | 1 |
| | 101CPM3050/4 | 31 | 51 | 82 | LN | 1 |
| | 101CPM4040/3 | 41 | 41 | 82 | LP | 1 |
| | 101CPM4040/4 | 41 | 41 | 82 | LN | 1 |
| | 101CPM3055/3 | 31 | 56 | 87 | LP | 1 |
| | 101CPM3055/4 | 31 | 56 | 87 | LN | 1 |
| | 101CPM3550/3 | 36 | 51 | 87 | LP | 1 |
| | 101CPM4045/3 | 41 | 46 | 87 | LP | 1 |
| | 101CPM4045/4 | 41 | 46 | 87 | LN | 1 |
| | 101CPM3060/3 | 31 | 61 | 92 | LP | 1 |
| | 101CPM3060/4 | 31 | 61 | 92 | LN | 1 |
| | 101CPM4050/3 | 41 | 51 | 92 | LP | 1 |
| | 101CPM4050/4 | 41 | 51 | 92 | LN | 1 |
| | 101CPM3065/3 | 31 | 66 | 97 | LP | 1 |
| | 101CPM3065/4 | 31 | 66 | 97 | LN | 1 |
| | 101CPM3070/3 | 31 | 71 | 102 | LP | 1 |
| 101CPM3070/4 | 31 | 71 | 102 | LN | 1 | |
| <ul style="list-style-type: none"> Single cylinder  | 101C3010/3 | 31 | 11 | 42 | LP | 1 |
| | 101C3010/4 | 31 | 11 | 42 | LN | 1 |
| | 101C3510/3 | 36 | 11 | 47 | LP | 1 |
| | 101C3510/4 | 36 | 11 | 47 | LN | 1 |
| | 101C4010/3 | 41 | 11 | 52 | LP | 1 |
| | 101C4010/4 | 41 | 11 | 52 | LN | 1 |
| | 101C4510/3 | 46 | 11 | 57 | LP | 1 |
| | 101C4510/4 | 46 | 11 | 57 | LN | 1 |
| | 101C5010/3 | 51 | 11 | 62 | LP | 1 |
| | 101C5010/4 | 51 | 11 | 62 | LN | 1 |
| | 101C5510/3 | 56 | 11 | 67 | LP | 1 |
| | 101C5510/4 | 56 | 11 | 67 | LN | 1 |
| | 101C6010/3 | 61 | 11 | 72 | LP | 1 |
| | 101C6010/4 | 61 | 11 | 72 | LN | 1 |

STANDARD EUROPEAN PROFILE CYLINDER
100C (5990) RANGE SHORT CAM

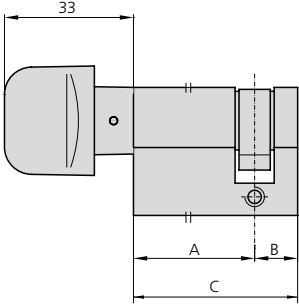
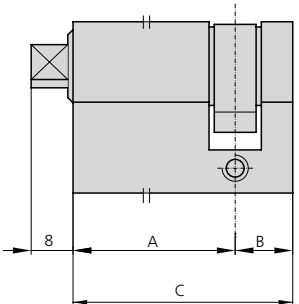
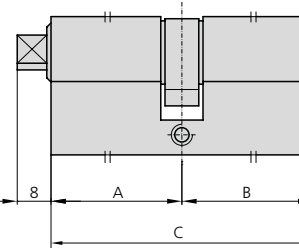
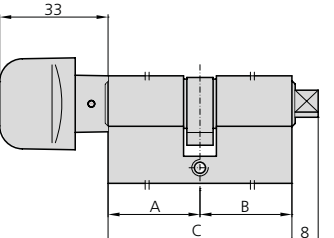
| DESCRIPTION | REF. | MEASUREMENTS | | | FINISH | UNITS |
|---|---------------|--------------|----|----|--------|-------|
| | | A | B | C | | |
| <ul style="list-style-type: none"> Single cylinder with knob  | 100CPM3010/3 | 31 | 11 | 42 | LP | 1 |
| | 100CPM3010/4 | 31 | 11 | 42 | LN | 1 |
| | 100CPM3510/3 | 36 | 11 | 47 | LP | 1 |
| | 100CPM3510/4 | 36 | 11 | 47 | LN | 1 |
| | 100CPM4010/3 | 41 | 11 | 52 | LP | 1 |
| | 100CPM4010/4 | 41 | 11 | 52 | LN | 1 |
| | 100CPM4510/3 | 46 | 11 | 57 | LP | 1 |
| | 100CPM4510/4 | 46 | 11 | 57 | LN | 1 |
| | 100CPM5010/3 | 51 | 11 | 62 | LP | 1 |
| | 100CPM5010/4 | 51 | 11 | 62 | LN | 1 |
| | 100CPM5510/3 | 56 | 11 | 67 | LP | 1 |
| | 100CPM5510/4 | 56 | 11 | 67 | LN | 1 |
| | 100CPM6010/3 | 61 | 11 | 72 | LP | 1 |
| | 100CPM6010/4 | 61 | 11 | 72 | LN | 1 |
| <ul style="list-style-type: none"> Single cylinder Triangle on one side  | 100CPT3010/3 | 31 | 11 | 42 | LP | 1 |
| | 100CPT3010/4 | 31 | 11 | 42 | LN | 1 |
| <ul style="list-style-type: none"> Double cylinder Key on one side and triangle on the other  | 101CPT3030/3 | 31 | 31 | 62 | LP | 1 |
| | 101CPT3030/4 | 31 | 31 | 62 | LN | 1 |
| | 101CPT3040/3 | 31 | 41 | 72 | LP | 1 |
| | 101CPT3040/4 | 31 | 41 | 72 | LN | 1 |
| | 101CPT3050/3 | 31 | 51 | 82 | LP | 1 |
| | 101CPT3050/4 | 31 | 51 | 82 | LN | 1 |
| <ul style="list-style-type: none"> Double cylinder Triangle on one side and knob on the other  | 100CPM30T30/3 | 31 | 31 | 62 | LP | 1 |
| | 100CPM30T30/4 | 31 | 31 | 62 | LN | 1 |
| | 100CPM35T35/3 | 36 | 36 | 72 | LP | 1 |
| | 100CPM35T35/4 | 36 | 36 | 72 | LN | 1 |
| | 100CPM40T30/3 | 41 | 31 | 72 | LP | 1 |
| | 100CPM40T30/4 | 41 | 31 | 72 | LN | 1 |
| | 100CPM40T40/3 | 41 | 41 | 82 | LP | 1 |
| | 100CPM40T40/4 | 41 | 41 | 82 | LN | 1 |
| | 100CPM35T50/3 | 36 | 51 | 87 | LP | 1 |
| | 100CPM35T50/4 | 36 | 51 | 87 | LN | 1 |