

## SLIDING DOORS

## MULTIPOINT WITH HOOK DEAD BOLT

 298K RANGE *slide & lock*

**CHARACTERISTIC**

- Key operated locking with 3 hook bolts
- **Anti-lifting system with hook bolts**
- 1850 x 16 x 6 mm SS front plate (other front plates upon request)
- 15mm closed box
- Cylinder set screw

**OPTIONAL ACCESSORIES**

- Complete range of **cylinders**
- Strike plate customization study
- Other front plates upon request

DESCRIPTION	REF.	MEASUREMENTS		CAM	FINISH		UNITS
		B	A		FRONT PLATE	CYLINDER	

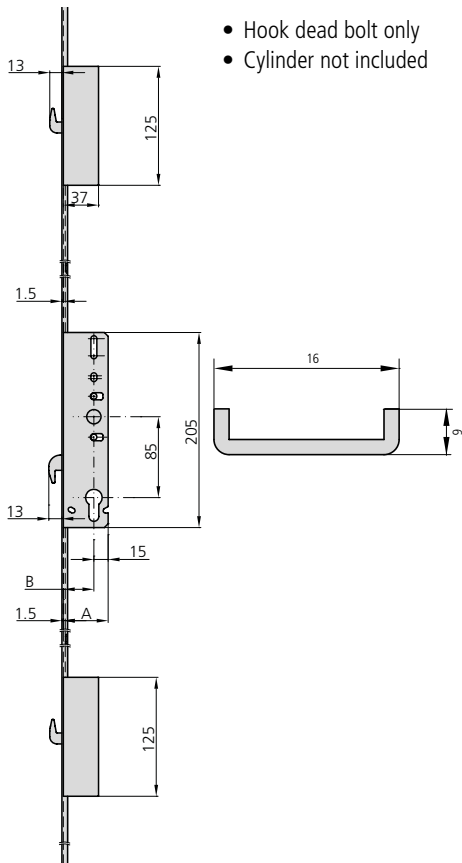

298K30/6U16	27	42	15	Al		1
298K35/6U16	32	47	15	Al		1