CHARACTERISTIC

- Nickel plated iron or stainless steel front plate
- Bichromate treated sides
- Sliding dead bolt
- Reversible latch bolt
- 8mm square ruler
- European profile cylinder
- 2 nylon escutcheons ref. ES1984
- Cylinder set screw

OPTIONAL ACCESSORIES

- Strike plates for given locks (see below)
- Complete range of cylinders

DESCRIPTION	REF.	MEASUREMENTS		CAM	FINISH		UNITS	
		B	A		FRONT PLATE	CYLINDER		

- Latch bolt and dead bolt
- Cylinder 101L3030

1995/32/0	32	47	15	HN	CN	1	20
1995/32/5	32	47	15	HN	CL	1	20
1995/32/6	32	47	15	Al	CN	1	20

Strike plate options

- CE1984/0 or CE1984/6

Electric strike plate options

- CELC45/6A or CELC45/6AD

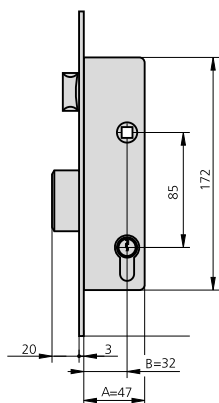

- Dead bolt only
- Cylinder 101L3030/4

1995A32/6	32	47	15	Al	CN	1	20
-----------	----	----	----	----	----	---	----

Strike plate options

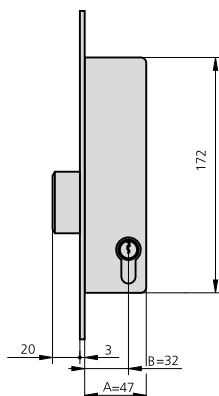

- CE2994S/6

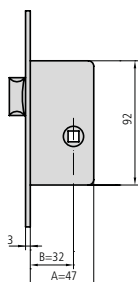

- Latch bolt only
- Without cylinder

1995R32/0	32	47		HN		1	30
-----------	----	----	--	----	--	---	----



DESCRIPTION	REF.	MEASUREMENTS		CAM	FINISH		UNITS	
		B	A		FRONT PLATE	CYLINDER		

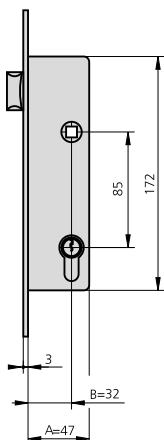

- Latch bolt only
- Cylinder 101L3010/4

1995T32/6	32	47	15	Al	CN	1	20
-----------	----	----	----	----	----	---	----

Electric strike plate options

- CELC45T/6A or CELC45T/6AD

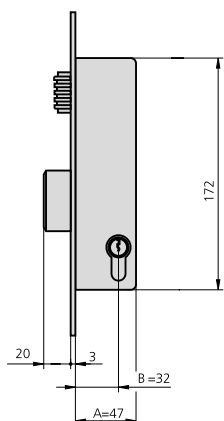

- Adjustable roller and dead bolt
- Cylinder 101L3030/4

1995V32/6	32	47	15	Al	CN	1	20
-----------	----	----	----	----	----	---	----

Strike plate options

- CE1984/6