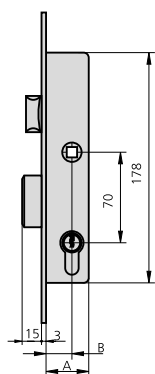

**CARACTÉRISTIQUES**

- Têtière en acier nickelé ou acier inoxydable
- Boîtier chromé
- Pêne dormant glissant
- Pêne demi-tour réversible
- Carré de 8 mm.
- Cylindre européen
- 2 cache-cylindre réf. ES1984
- Vis de fixation de cylindre.

**ACCESSOIRES EN OPTION**

- Gâches selon serrure (voir ci-dessous)
- Gamme complète de cylindres (voir pages 128 - 154)

| DESCRIPTION | RÉF. | DIMENSIONS PANNETON |   |  | FINITIONS |          | PIÈCES |  |
|-------------|------|---------------------|---|--|-----------|----------|--------|--|
|             |      | B                   | A |  | TÊTIÈRE   | CYLINDRE |        |  |



- Pêne demi-tour et pêne dormant
- Cylindre 101C3030

- Gâches en option**
- CE1983/6

- Option gâches électriques**

- CELC45/6A ou CELC45/6AD

|           |    |    |       |    |    |   |    |
|-----------|----|----|-------|----|----|---|----|
| 1983/20/0 | 20 | 33 | 13,25 | HN | CN | 1 | 20 |
| 1983/20/5 | 20 | 33 | 13,25 | HN | CL | 1 | 20 |
| 1983/20/6 | 20 | 33 | 13,25 | AI | CN | 1 | 20 |
| 1983/25/0 | 25 | 38 | 13,25 | HN | CN | 1 | 20 |
| 1983/25/5 | 25 | 38 | 13,25 | HN | CL | 1 | 20 |
| 1983/25/6 | 25 | 38 | 13,25 | AI | CN | 1 | 20 |
| 1983/30/0 | 30 | 43 | 13,25 | HN | CN | 1 | 20 |
| 1983/30/5 | 30 | 43 | 13,25 | HN | CL | 1 | 20 |
| 1983/30/6 | 30 | 43 | 13,25 | AI | CN | 1 | 20 |

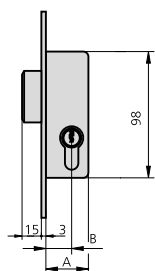

- Pêne uniquement
- Cylindre 101C3030

- Gâches en option**
- CE2994S/6

|           |    |    |       |    |    |   |    |
|-----------|----|----|-------|----|----|---|----|
| 1983A20/0 | 20 | 33 | 13,25 | HN | CN | 1 | 30 |
| 1983A20/5 | 20 | 33 | 13,25 | HN | CL | 1 | 30 |
| 1983A25/0 | 25 | 38 | 13,25 | HN | CN | 1 | 30 |
| 1983A25/5 | 25 | 38 | 13,25 | HN | CL | 1 | 30 |
| 1983A30/0 | 30 | 43 | 13,25 | HN | CN | 1 | 30 |
| 1983A30/5 | 30 | 43 | 13,25 | HN | CL | 1 | 30 |

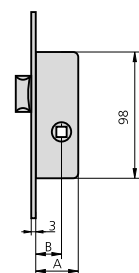



- Serrure de condamnation
- Sans cylindre

|           |    |    |  |    |  |   |    |
|-----------|----|----|--|----|--|---|----|
| 1983R20/0 | 20 | 33 |  | HN |  | 2 | 60 |
| 1983R25/0 | 25 | 38 |  | HN |  | 2 | 60 |
| 1983R30/0 | 30 | 43 |  | HN |  | 1 | 30 |

- Gâches en option**
- CE1991/0

**PÊNE DORMANT GLISSANT ENTRE-AXES 70 CYLINDRE EUROPÉEN**

**SÉRIE 1983**

| DESCRIPTION | RÉF. | DIMENSIONS PANNETON |   | FINITIONS |          | PIÈCES  |   |
|-------------|------|---------------------|---|-----------|----------|---|---|
|             |      | B                   | A | TÊTIÈRE   | CYLINDRE |  |  |

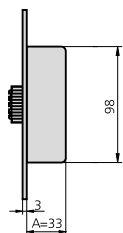

- Pêne demi-tour uniquement
- Sans cylindre

|          |    |    |   |    |
|----------|----|----|---|----|
| 1983RV/0 | 33 | HN | 2 | 60 |
|----------|----|----|---|----|

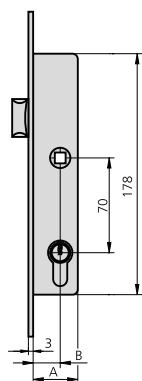

- Avec pêne 1/2 tour seulement
- Cylindre 101L3010/4

**Option gâches électriques**

- CELC45T/6A ou CELC45T/6AD

|           |    |    |    |    |    |   |    |
|-----------|----|----|----|----|----|---|----|
| 1983T20/6 | 20 | 33 | 15 | Al | CN | 1 | 20 |
| 1983T25/6 | 25 | 38 | 15 | Al | CN | 1 | 20 |
| 1983T30/6 | 30 | 43 | 15 | Al | CN | 1 | 20 |