

ACCESSORIES

STAINLESS STEEL ESCUTCHEONS AND HANDLES



CHARACTERISTICS

- Stainless steel handles certified in accordance with EN 179 test

DESCRIPTION	REF.	FINISH	CYLINDER	UNITS
-------------	------	--------	----------	-------

- Escutcheon with handle and cylinder keyhole
- 55 mm between axes
- Cylinder not included

CM5006I55/6R	AI	Round	1
CM5006D55/6R	AI	Round	1

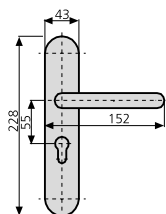

- Escutcheon with handle and cylinder keyhole
- 72 mm between axes
- Cylinder not included

CM5006I72/6R	AI	Round	1
CM5006D72/6R	AI	Round	1

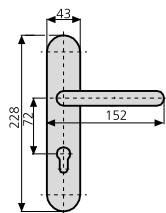

- Escutcheon with handle and cylinder keyhole
- 85 mm between axes
- Cylinder not included

CM5006I85/6R	AI	Round	1
CM5006D85/6R	AI	Round	1

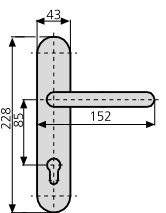

- Escutcheon with handle

CM5007I/6R	AI	Round	1
CM5007D/6R	AI	Round	1

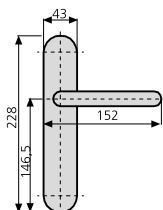

ACCESSORIES

BLACK ESCUTCHEONS AND HANDLES



CHARACTERISTICS

- Black painted handles

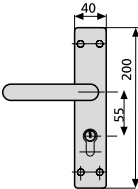
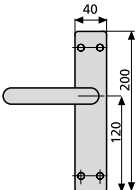
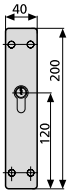
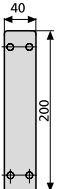
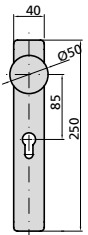
DESCRIPTION	REF.	FINISH	CANTO	UNITS	
	<ul style="list-style-type: none">• Escutcheon with handle and cylinder keyhole• 55 mm between axes• Includes cylinder B5000	M5000D/1N M5000I/1N	Black Black	Square Square	1 1
	<ul style="list-style-type: none">• Escutcheon with handle	M5001/1N	Black	Square	1
	<ul style="list-style-type: none">• Escutcheon with cylinder keyhole• 55 mm between axes• Includes cylinder B5000	M5002/1N	Black	Square	1
	<ul style="list-style-type: none">• Blind escutcheon	M5003/1N	Black	Square	1
	<ul style="list-style-type: none">• Escutcheon with knob and cylinder keyhole• Includes cylinder B5000	M5004/1N	Black	Square	1