

## CYLINDRES OVALES ET ROUNDS

## SÉRIE 5963

## CARACTÉRISTIQUES

- Petit cylindre ovale
- Corps en laiton
- Rotors en laiton
- Deux pannetons
- 3 clés

## ACCESSOIRES EN OPTION

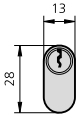

## DESCRIPTION

## RÉF.

## DIMENSIONS

A B C

## FINITIONS

APPLICABLE À  
SERRURES

## PIÈCES

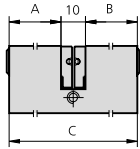

- Cylindre double

5963/2222/3	22	22	54	LP	1963 1975	1
5963/2222/4	22	22	54	LN		1
5963/2525/3	26	26	62	LP		1
5963/2525/4	26	26	62	LN		1
5963/3030/3	31	31	72	LP		1
5963/3030/4	31	31	72	LN		1
5963/3535/3	36	36	82	LP		1
5963/3535/4	36	36	82	LN		1
5963/4040/3	41	41	92	LP		1
5963/4040/4	41	41	92	LN		1

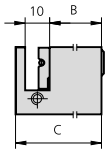

- Demi cylindre

5963T36/3		22	36	LP	1963 1975	1
5963T36/4		22	36	LN		1