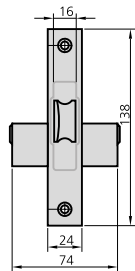

LOCK WITH OVAL CYLINDER FOR DOORS WITH SKIRTING BOARD
SERIE 1981

CHARACTERISTICS

- Nickel plated iron front plate
- Bichromate treated sides
- Extensible and reversible latch bolt
- Extensible operated by key
- Latch bolt operated by key and handle
- 8mm square ruler
- Monoblock oval cylinder (5081) or monoblock round cylinder (5181)
- 2 nylon escutcheons ref. ES1964 or ES1962/4
- Cylinder set screw
- Strike plate CE1991/0

OPTIONAL ACCESSORIES

- Cylinders

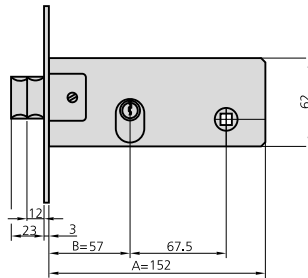
DESCRIPTION	REF.	MEASUREMENTS		FINISH		UNITS	
		B	A	FRONT PLATE	CYLINDER		
<ul style="list-style-type: none"> • Oval cylinder 5081/3030 • Strike plate CE1991/0 • Nylon escutcheon ES1964 	1981/60/0	57	152	HN	CN	1	20
	1981/60/5	57	152	HN	CL	1	20

OVAL CYLINDER

ROUND CYLINDER

- Round cylinder 5181/3030
- Strike plate CE1991/0
- Nylon escutcheon ES1962/4

11981/60/0	57	152	HN	CN	1	20
11981/60/5	57	152	HN	CL	1	20

OVAL CYLINDER

- Extensible roller
- Oval cylinder 5081/3030
- Strike plate CE1991/0
- Nylon escutcheon ES1964

1981V60/0	57	152	HN	CN	1	20
1981V60/5	57	152	HN	CL	1	20

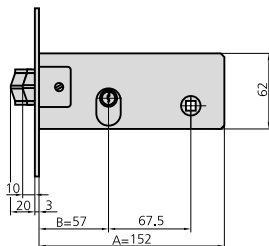
ROUND CYLINDER

- Extensible roller
- Round cylinder 5181/3030
- Strike plate CE1991/0
- Nylon escutcheon ES1962/4

11981V60/0	57	152	HN	CN	1	20
11981V60/5	57	152	HN	CL	1	20