

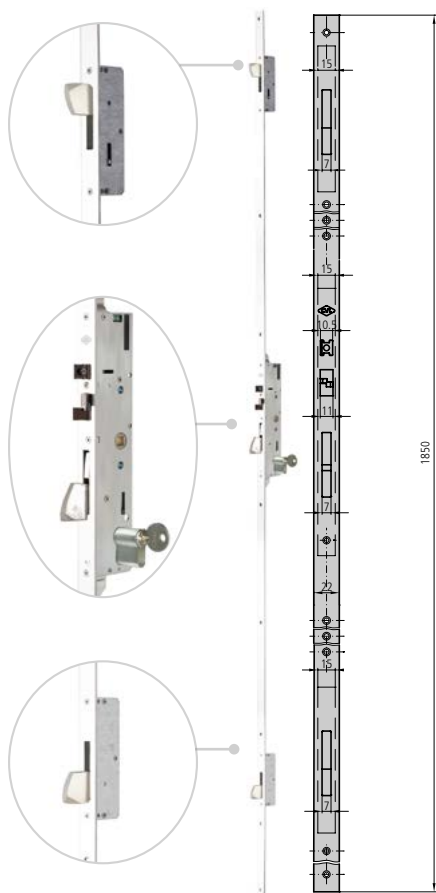

## MULTIPOINT WITH TILTING DEAD BOLT, 85 mm BETWEEN AXES

## 2K5 RANGE **DUE**



### CHARACTERISTIC

- 12V electric lock with automatic opening with handle or cylinder
- 3 points lock with 16 mm, 22 mm and 24 mm SS flat front plate or 24,5\*6 "U" shape SS front plate
- 1850mm long front plate
- Anticard system
- Compatible with AC and DC
- Minimum effort for door closing
- 15 mm closed box
- 8mm square ruler
- Passing security escutcheon ref. BTI196/1N
- Strike plate according to the lock
- Cylinder set screw

### OPTIONAL ACCESSORIES

- Complete range of **strike plates**
- Complete range of **cylinders**
- In option 2300 mm long front plate (4K5 range)
- In option 1500 mm long front plate (5K5 range)
- Electrical contacts (see page 55) CONECT01

### DESCRIPTION

### REF.

### MEASUREMENTS CAM

### FINISH

### UNITS

B

A

FRONT PLATE CYLINDER

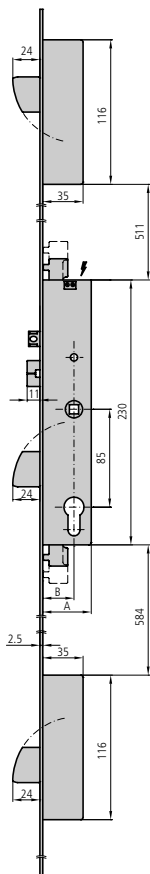

- Latch bolt and dead bolt
- Cylinder not included
- Central strike plate included ref. KCE1K5/6L
- 2 high/low strike plates included: CE296S/6L

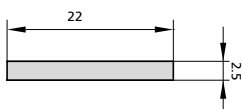

2K5/30/6L	27	42	15	Al	1
2K5/33/6L	30	43	13,25	Al	1
2K5/35/6L	32	47	15	Al	1

\* Other front plates upon request.