



ACCESORIOS

CERRADEROS PARA CERRADURAS METÁLICAS

DESCRIPCIÓN	REF.	ACABADO	APLICABLE A CERRADURAS	UDS  
-------------	------	---------	------------------------	---

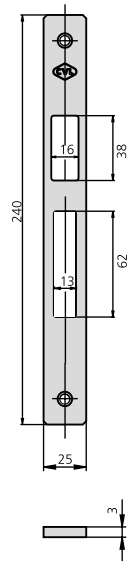

CE1983/6 Al 1983

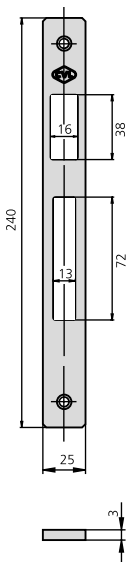

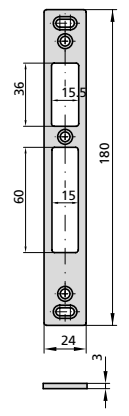

CE1984

CE1984/0 HN 1984, 1992, 1995,
 CE1984/6 Al 1964, 1963, 1975



CE190/0 HN 190
 CE190/6 Al 190

ACCESORIOS
CERRADEROS PARA CERRADURAS METÁLICAS

DESCRIPCIÓN	REF.	ACABADO	APLICABLE A CERRADURAS	UDS  
-------------	------	---------	------------------------	---

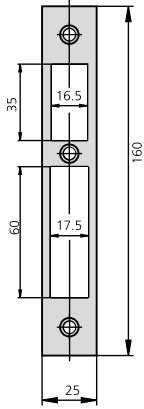

CE1990/0 HN 1990

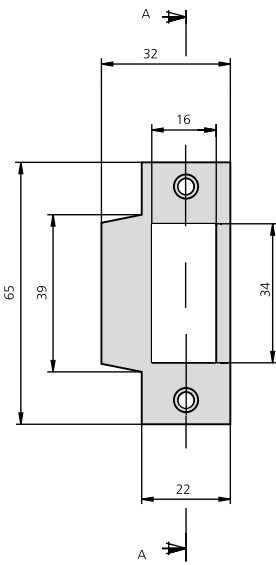
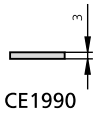

CE1991/0 HN 1991, 1981, 11981

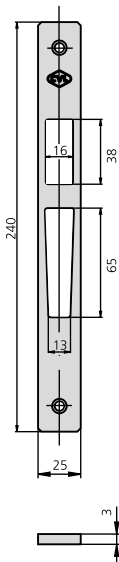

CE1994/6 Al 1994, 2994, 3994

ACCESORIOS

CERRADEROS PARA CERRADURAS METÁLICAS

DESCRIPCIÓN	REF.	ACABADO	APLICABLE A CERRADURAS	UDS 
-------------	------	---------	------------------------	---

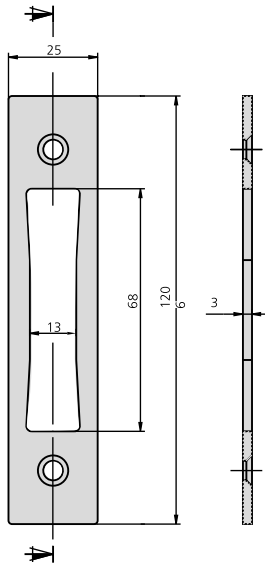

CE2994S/6

Al

1983A, 1963A, 1975A,
1995A, arriba/abajo 2994,
1982, 1968

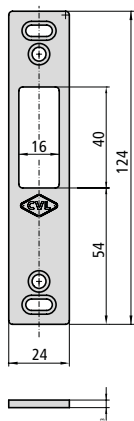

CE1975R/0

HN

1963R, 1963RV, 1964R,
1964RV, 1964T, 1975R,
1979R, 1983R, 1983RV,
1983T, 1984T, 1992T,
1995R, 1995T