

PALANCA DESLIZANTE ENTRE EJES 70 CILINDRO EUROPERFIL

SERIE 1983

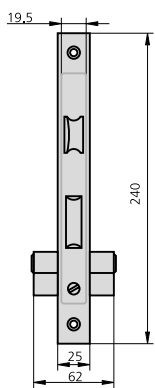

CARACTERÍSTICAS

- Frente hierro niquelado o acero inoxidable
- Caja bicromatada
- Palanca deslizante
- Picaporte reversible
- Cuadradillo de 8 mm
- Cilindro europerfil
- 2 escudos de nylon ref. ES1984
- Tornillo de fijación de cilindro

ACCESORIOS OPCIONALES

- Cerraderos según cerradura (ver abajo)
- Gama completa de cilindros

| DESCRIPCIÓN | REF. | MEDIDAS | | LEVA | ACABADOS | | UDS | |
|-------------|------|---------|---|------|----------|----------|-----|--|
| | | B | A | | FRENTE | CILINDRO | | |

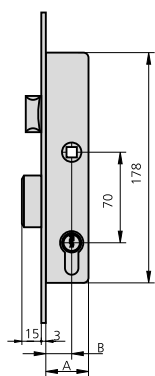

| | | | | | | | | |
|---------------------------------------|-----------|----|----|-------|----|----|---|----|
| • Picaporte y palanca | 1983/20/0 | 20 | 33 | 13,25 | HN | CN | 1 | 20 |
| • Cilindro 5990/2525 | 1983/20/5 | 20 | 33 | 13,25 | HN | CL | 1 | 20 |
| | 1983/20/6 | 20 | 33 | 13,25 | AI | CN | 1 | 20 |
| Opciones de cerradero | 1983/25/0 | 25 | 38 | 13,25 | HN | CN | 1 | 20 |
| • CE1983/0 o CE1983/6 | 1983/25/5 | 25 | 38 | 13,25 | HN | CL | 1 | 20 |
| Opciones cerraderos eléctricos | 1983/25/6 | 25 | 38 | 13,25 | AI | CN | 1 | 20 |
| • CELC45/6A o CELC45 /6AD | 1983/30/0 | 30 | 43 | 13,25 | HN | CN | 1 | 20 |
| | 1983/30/5 | 30 | 43 | 13,25 | HN | CL | 1 | 20 |
| | 1983/30/6 | 30 | 43 | 13,25 | AI | CN | 1 | 20 |

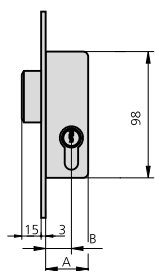

| | | | | | | | | |
|------------------------------|-----------|----|----|-------|----|----|---|----|
| • Sólo palanca | 1983A20/0 | 20 | 33 | 13,25 | HN | CN | 1 | 30 |
| • Cilindro 5990/2525 | 1983A20/5 | 20 | 33 | 13,25 | HN | CL | 1 | 30 |
| | 1983A25/0 | 25 | 38 | 13,25 | HN | CN | 1 | 30 |
| Opciones de cerradero | 1983A25/5 | 25 | 38 | 13,25 | HN | CL | 1 | 30 |
| • CE2994S/6 | 1983A30/0 | 30 | 43 | 13,25 | HN | CN | 1 | 30 |
| | 1983A30/5 | 30 | 43 | 13,25 | HN | CL | 1 | 30 |

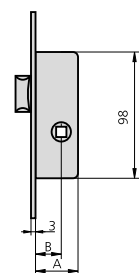

| | | | | | | | | |
|-------------------------------|-----------|----|----|--|----|--|---|----|
| • Cerradura de sólo picaporte | 1983R20/0 | 20 | 33 | | HN | | 2 | 60 |
| | 1983R25/0 | 25 | 38 | | HN | | 2 | 60 |
| • Sin cilindro | 1983R30/0 | 30 | 43 | | HN | | 2 | 60 |

PALANCA DESLIZANTE ENTRE EJES 70 CILINDRO EUROPERFIL
SERIE 1983

| DESCRIPCIÓN | REF. | MEDIDAS | | LEVA | ACABADOS | | UDS | |
|-------------|------|---------|---|------|----------|----------|-----|--|
| | | B | A | | FRENTE | CILINDRO | | |

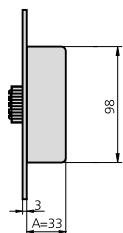

- Cerradura de sólo vaivén
- Sin cilindro

| | | | | |
|----------|----|----|---|----|
| 1983RV/0 | 33 | HN | 2 | 60 |
|----------|----|----|---|----|

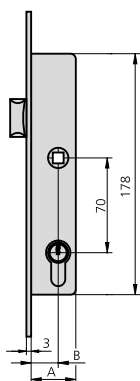

- Sólo picaporte
- Cilindro 5982T40/4

| | | | | | | | |
|-----------|----|----|----|----|----|---|----|
| 1983T20/6 | 20 | 33 | 15 | Al | CN | 1 | 20 |
| 1983T25/6 | 25 | 38 | 15 | Al | CN | 1 | 20 |
| 1983T30/6 | 30 | 43 | 15 | Al | CN | 1 | 20 |

Opciones de cerraderos eléctricos

- CELC45T/6A o CELC45T/6AD