

## MORTISE LOCKS FOR METAL WORK / SERRURES À LARDER POUR MENUISERIE MÉTALLIQUE

Sliding dead bolt, 85 mm between axes, double european profile cylinder, short cam / <i>Pêne coulissant entre-axes 85 cylindre europrofil came courte</i>	36 36
• 1984 Series / <i>Série 1984</i>	
Sliding dead bolt, 85 mm between axes, double european profile cylinder, long cam / <i>Pêne coulissant entre-axes 85 cylindre europrofil came longue</i>	38 38
• 1995 Series / <i>Série 1995</i>	
Hook dead bolt, 85 mm between axes, double europea profile cylinder / <i>Pêne à crochet entre-axes 85 cylindre europrofil</i>	40 40 41
• 1990 Series / <i>Série 1990</i>	
• 1994 Series / <i>Série 1994</i>	
Multipoint hook dead bolt, 85 mm between axes / <i>Pêne a crochet multipoint entre-axes 85</i>	43 43
• 2994 Series / <i>Série 2994</i>	
Multipoint hook dead bolt, 85 mm between axes / <i>Pêne a crochet multipoint entre-axes 85</i>	45 45 47
• 3994 Series / <i>Série 3994</i>	
• 4994 Series / <i>Série 4994</i>	
Sliding dead bolt, 92 mm between axes, double european profile cylinder / <i>Pêne coulissant entre-axes 92 cylindre europrofil</i>	49 49
• 1992 Series / <i>Série 1992</i>	
Sliding dead bolt, 70 mm between axes, double european profile cylinder / <i>Pêne coulissant entre-axes 70 cylindre europrofil</i>	50 50
• 1983 Series / <i>Série 1983</i>	
Sliding dead bolt, 85 mm between axes, monoblock oval cylinder / <i>Pêne coulissant entre-axes 85 cylindre ovale monobloc</i>	52 52 54
• 1963 Series / <i>Série 1963</i>	
• 1975 Series / <i>Série 1975</i>	
Sliding dead bolt, 85 mm between axes, oval cylinder / <i>Pêne coulissant entre-axes 85 cylindre ovale d'axes</i>	55 55
• 1964 Series / <i>Série 1964</i>	
Lock with oval cylinder for doors with skirting board / <i>Serrure pour portes de soubassement avec cylindre ovale à tiges</i>	57 57
• 1981 Series / <i>Série 1981</i>	
Lock with double cylinder for doors with skirting boards / <i>Serrure pour portes de soubassement avec cylindre europrofil</i>	58 58
• 1991 Series / <i>Série 1991</i>	
Lock with hook only with oval cylinder / <i>Serrure à crochet uniquement avec cylindre ovale d'axes</i>	59 59
• 1968 Series / <i>Série 1968</i>	
Lock with hook only with european profile cylinder / <i>Serrure à crochet uniquement avec cylindre europrofil</i>	60 60
• 1982 Series / <i>Série 1982</i>	
Lock with latch bolt only for metal doors / <i>Serrure à demi-tour uniquement pour portes métalliques</i>	61 61
• 1979 Series / <i>Série 1979</i>	
Lock for metal roll-up doors and persian blinds / <i>Serrure pour portes et persiennes métalliques enroulables</i>	62 62 63
• 11A Series / <i>Série 11A</i>	
• 11E Series / <i>Série 11E</i>	
Lock for hinged metal doors / <i>Serrure pour portes métalliques basculantes</i>	64 64
• 11B Series / <i>Série 11B</i>	
Accessories / <i>Accessoires</i>	65 65 68 68
• Strike plates for metal locks / <i>Gâches pour serrures métalliques</i>	
• Escutcheons / <i>Plaques</i>	
• Security escutcheons / <i>Plaques de sécurité</i>	



**SLIDING DEAD BOLT, 85 mm BETWEEN AXES, DOUBLE EUROPEAN PROFILE CYLINDER, SHORT CAM / PÊNE COULISSANT ENTRE-AXES 85 EUROPROFIL CAME COURTE**

**1984 SERIES / SÉRIE 1984**

**CHARACTERISTICS / CARACTÉRISTIQUES**

**OPTIONAL ACCESSORIES / ACCESSOIRES OPTIONNELS**

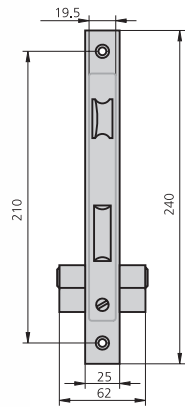

- Nickel plated iron or stainless steel face plate  
*Têtière en fer nickelé ou acier inoxydable*
- Bichromate treated sides  
*Boîtier bichromé*
- Sliding dead bolt / *Pêne coulissant*
- Reversible latch bolt  
*Demi-tour réversible*
- 8mm square ruler / *Carré de 8mm*
- Double european profile cylinder  
*Cylindre europrofil*
- 2 nylon escutcheons ref. ES1984  
*2 plaques en nylon réf. ES1984*
- Cylinder set screw / *Vis de fixation*

- Strike plates for given locks  
*Gâches selon serrure*  
(See below / voir ci-dessous)
- Complete range of cylinders  
*Gamme complète de cylindres*  
(See page / voir page 111-120)

**DESCRIPTION**

**REF. RÉF.**

**MEASUREMENTS DIMENSIONS**

**CAM CAME**

**FINISH FINITIONS**

**UNITS PIÈCES**

**B**

**A**

**FRONT PLATE TÊTIÈRE**

**CYLINDER CYLINDRE**

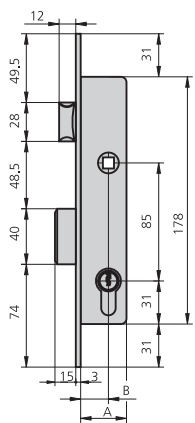

- Latch bolt and dead bolt  
*Demi-tour et pêne*
- Cylinder 5990/2525  
*Cylindre 5990/2525*

**Strike plate options Options de gâche**

- CE1984/0 or / ou CE1984/6

**Electric strike plate option Option gâche électrique**

- CELC196/6A or / ou CELC196/6AD

1984/20/0	20	33	13,25	HN	CN	1	20		
1984/20/5	20	33	13,25	HN	CL	1	20		
1984/20/6	20	33	13,25	AI	CN	1	20		
1984/25/0	25	38	13,25	HN	CN	1	20		
1984/25/5	25	38	13,25	HN	CL	1	20		
1984/25/6	25	38	13,25	AI	CN	1	20		
1984/30/0	30	43	13,25	HN	CN	1	20		
1984/30/5	30	43	13,25	HN	CL	1	20		
1984/30/6	30	43	13,25	AI	CN	1	20		

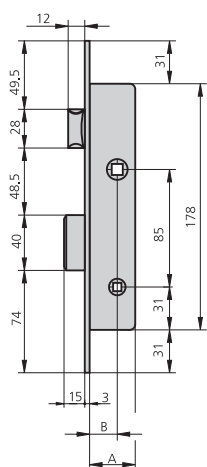

- Lock with dead bolt  
*Serrure de condamnation*
- Without cylinder  
*Sans cylindre*

**Strike plate options Options de gâche**

- CE1984/6

1984C20/6	20	33		AI		2	40		
1984C25/6	25	38		AI		2	40		
1984C30/6	30	43		AI		2	40		

**SLIDING DEAD BOLT, 85 mm BETWEEN AXES, DOUBLE EUROPEAN PROFILE CYLINDER, SHORT CAM / PÊNE COULISSANT ENTRE-AXES 85 EUROPROFIL CAME COURTE**

**1984 SERIES / SÉRIE 1984**

DESCRIPTION	REF. RÉF.	MEASUREMENTS DIMENSIONS		CAM CAME	FINISH FINITIONS		UNITS PIÈCES			
		B	A		FRONT PLATE TÊTIÈRE	CYLINDER CYLINDRE				

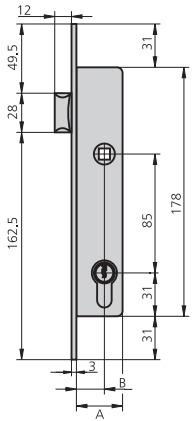

- Latch bolt only  
*Demi-tour uniquement*
- Cylinder 5982T40/4  
*Cylindre 5982T40/4*

**Electric strike plate option**  
*Option gâche électrique*

- CELC196T/6A or / ou  
CELC196T/6AD

1984T20/6	20	33	15	Al	CN	1	20		
1984T25/6	25	38	15	Al	CN	1	20		
1984T30/6	30	43	15	Al	CN	1	20		

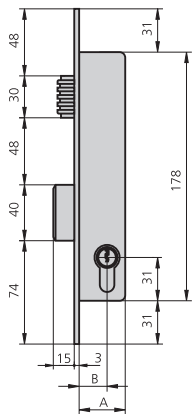

- Adjustable roller and dead bolt  
*Rouleau réglable et demi-tour*
- Cylinder 5990/2525  
*Cylindre 5990/2525*

**Strike plate options**  
*Options de gâche*

- CE1984/6

1984V20/6	20	33	13,25	Al	CN	1	20		
1984V25/6	25	38	13,25	Al	CN	1	20		
1984V30/6	30	43	13,25	Al	CN	1	20		

**SLIDING DEAD BOLT, 85 mm BETWEEN AXES, DOUBLE EUROPEAN PROFILE CYLINDER, LONG CAM / PÊNE COULISSANT ENTRE AXES 85 EUROPROFIL CAME LONGUE**

**1995 SERIES / SÉRIE 1995**

**CHARACTERISTICS /  
CARACTÉRISTIQUES**

**OPTIONAL ACCESSORIES /  
ACCESSOIRES OPTIONELS**

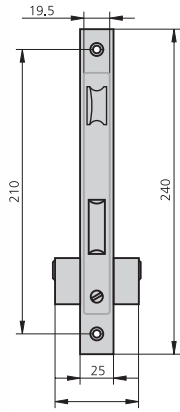

- Nickel plated iron or stainless steel face plate  
*Têtière fer nickelé ou acier inoxydable*
- Bichromate treated sides  
*Boîtier bichromé*
- Sliding dead bolt / *Pêne coulissant*
- Reversible latch bolt  
*Demi-tour réversible*
- 8mm square ruler / *Carré de 8mm*
- Double european profile cylinder  
*Cylindre europrofil*
- 2 nylon escutcheons ref. ES1984  
*2 plaques en nylon réf.ES1984*
- Cylinder set screw  
*Vis de fixation de cylindre*

- Strike plates for given locks  
*Gâches selon serrure*  
(See below / voir ci-dessous)
- Complete range of cylinders  
*Gamme complète de cylindres*  
(See page / voir page 111-120)

DESCRIPTION	REF. RÉF.	MEASUREMENTS DIMENSIONS		CAM CAME	FINISH FINITIONS		UNITS PIÈCES			
		B	A		FRONT PLATE TÊTIÈRE	CYLINDER CYLINDRE				

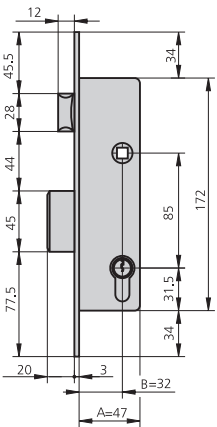

- Latch bolt and dead bolt  
*Demi-tour et pêne*
- Cylinder 5982/2525  
*Cylindre 5982/2525*

1995/32/0	32	47	15	HN	CN	1	20		
1995/32/5	32	47	15	HN	CL	1	20		
1995/32/6	32	47	15	Al	CN	1	20		

**Strike plate options  
Options de gâche**

- CE1984/0 or / ou CE1984/6

**Electric strike plate option  
Option gâche électrique**

- CELC196/6A or / ou CELC196/6AD

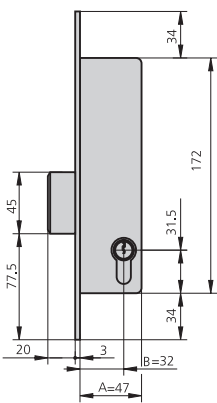

- Dead bolt only  
*Pêne uniquement*
- Cylinder 5982/2525/4  
*Cylindre 5982/2525/4*

1995A32/6	32	47	15	Al	CN	1	20		
-----------	----	----	----	----	----	---	----	--	--

**Strike plate options  
Options de gâche**

- CE2994S/6

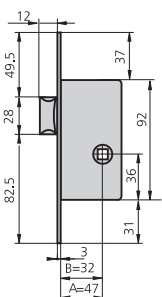

- Latch bolt only  
*Demi-tour uniquement*
- Without cylinder  
*Sans cylindre*

1995R32/0	32	47		HN		1	30		
-----------	----	----	--	----	--	---	----	--	--

**SLIDING DEAD BOLT, 85 mm BETWEEN AXES, DOUBLE EUROPEAN PROFILE CYLINDER, LONG CAM / PÊNE COULISSANT ENTRE AXES 85 EUROPROFIL CAME LONGUE**

**1995 SERIES / SÉRIE 1995**

DESCRIPTION	REF. RÉF.	MEASUREMENTS DIMENSIONS		CAM CAME	FINISH FINITIONS		UNITS PIÈCES	
		B	A		FRONT PLATE TÊTIÈRE	CYLINDER CYLINDRE		

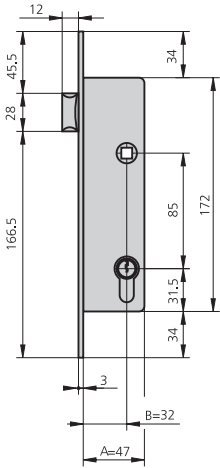

- Latch bolt only  
*Demi-tour uniquement*
- Cylinder 5982T40/4  
*Cylindre 5982T40/4*

**Electric strike plate option**  
*Option gâche électrique*

- CELC196/6A or /ou  
CELC196/6AD

1995T32/6	32	47	15	Al	CN	1	20		
-----------	----	----	----	----	----	---	----	--	--

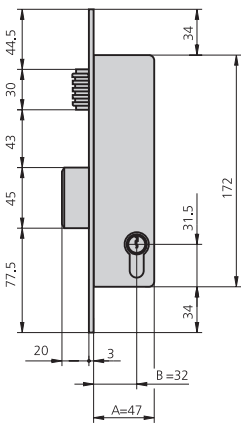

- Adjustable roller and dead bolt  
*Rouleau réglable et pêne*
- Cylinder 5982/2525/4  
*Cylindre 5982/2525/4*

**Strike plate options**  
*Options de gâche*

- CE1984/6

1995V32/6	32	47	15	Al	CN	1	20		
-----------	----	----	----	----	----	---	----	--	--

**HOOK DEAD BOLT, 85 mm BETWEEN AXES, DOUBLE EUROPEAN PROFILE CYLINDER /  
PÊNE À CROCHET ENTRE AXES 85 CYLINDRE EUROPROFIL**

**1990 SERIES / SÉRIE 1990**

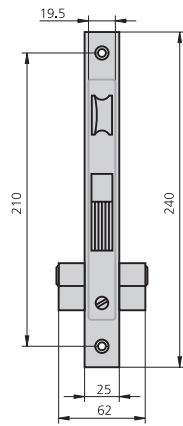

**CHARACTERISTICS /  
CARACTÉRISTIQUES**

- Nickel plated iron or stainless steel face plate / *Têtière en fer nickelé ou acier inoxydable*
- Bichromate treated sides / *Boîtier bichromé*
- Tilting hook dead bolt / *Pêne basculant à crochet*
- Reversible latch bolt / *Demi-tour réversible*
- 8mm square ruler / *Carré de 8mm*
- Double european profile cylinder / *Cylindre europrofil*
- 2 nylon escutcheons ref. ES1984 / *2 plaques en nylon réf. 1984*
- Cylinder set screw / *Vis de fixation de cylindre*

**OPTIONAL ACCESSORIES /  
ACCESSOIRES OPTIONNELS**

- Complete range of cylinders / *Gamme complète de cylindres*  
(See page / voir page 111-120)

**DESCRIPTION**

REF. RÉF.	MEASUREMENTS DIMENSIONS		CAM CAME	FINISH FINITIONS		UNITS PIÈCES	
	B	A		FRONT PLATE TÊTIÈRE	CYLINDER CYLINDRE		

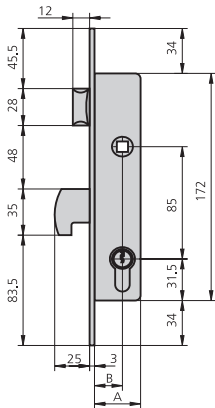

- Latch bolt and dead bolt / *Demi-tour et pêne*
- Cylinder 5990/2525 or 5982/2525 / *Cylindre 5990/2525 ou 5982/2525*
- Strike plates CE1990/0 / *Gâches CE1990/0*

1990/20/0	20	33	13,25	HN	CN	1	20
1990/20/5	20	33	13,25	HN	CL	1	20
1990/20/6	20	33	13,25	AI	CN	1	20
1990/25/0	25	38	13,25	HN	CN	1	20
1990/25/5	25	38	13,25	HN	CL	1	20
1990/25/6	25	38	13,25	AI	CN	1	20
1990/32/0	32	47	15	HN	CN	1	20
1990/32/5	32	47	15	HN	CL	1	20
1990/32/6	32	47	15	AI	CN	1	20

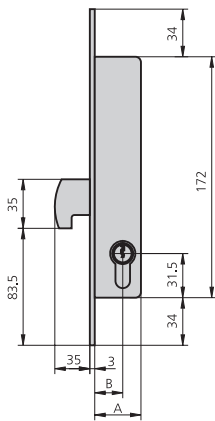

- Dead bolt only / *Pêne uniquement*
- Cylinder 5990/2525 or 5982/2525 / *Cylindre 5990/2525 ou 5982/2525*
- Strike plate CE1990/0 / *Gâche CE1990/0*

1990A20/0	20	33	13,25	HN	CN	1	20
1990A20/5	20	33	13,25	HN	CL	1	20
1990A20/6	20	33	13,25	AI	CN	1	20
1990A25/0	25	38	13,25	HN	CN	1	20
1990A25/5	25	38	13,25	HN	CL	1	20
1990A25/6	25	38	13,25	AI	CN	1	20
1990A32/0	32	47	15	HN	CN	1	20
1990A32/5	32	47	15	HN	CL	1	20
1990A32/6	32	47	15	AI	CN	1	20

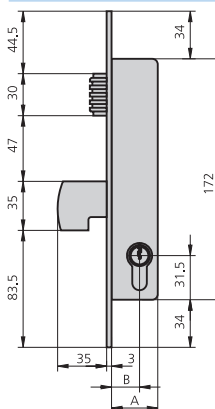

- Adjustable roller and dead bolt / *Rouleau réglable et pêne*
- Cylinder 5990/2525 or 5982/2525 / *Cylindre 5990/2525 ou 5982/2525*
- Strike plates CE1990/0 / *Gâches CE1990/0*

1990V20/0	20	33	13,25	HN	CN	1	20
1990V20/5	20	33	13,25	HN	CL	1	20
1990V20/6	20	33	13,25	AI	CN	1	20
1990V25/0	25	38	13,25	HN	CN	1	20
1990V25/5	25	38	13,25	HN	CL	1	20
1990V25/6	25	38	13,25	AI	CN	1	20
1990V32/0	32	47	15	HN	CN	1	20
1990V32/5	32	47	15	HN	CL	1	20
1990V32/6	32	47	15	AI	CN	1	20

**HOOK DEAD BOLT, 85 mm BETWEEN AXES, DOUBLE EUROPEAN PROFILE CYLINDER /  
PÈNE À CROCHET ENTRE AXES 85 CYLINDRE EUROPROFIL**

**1994 SERIES / SÉRIE 1994**

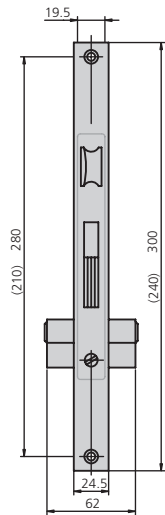

**CHARACTERISTICS /  
CARACTÉRISTIQUES**

- Stainless steel front plate  
*Têtière en acier inoxydable*
- Bichromate treated sides / *Boîtier bichromé*
- Tilting hook dead bolt  
*Pêne basculant à crochet*
- Reversible latch bolt / *Demi-tour réversible*
- 8mm square ruler / *Carré de 8mm*
- Double european profile cylinder  
*Cylindre europrofil*
- Cylinder set screw  
*Vis de fixation de cylindre*
- Strike plate for given locks  
*Gâche selon serrure*
- Security escutcheon BT194/1N  
*Plaque de sécurité BT194/1N*

**OPTIONAL ACCESSORIES /  
ACCESSOIRES OPTIONELS**

- Complete range of cylinders  
*Gamme complète de cylindres*  
(See page / voir page 111-120)

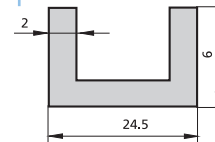

U-SHAPED FRONT PLATE / TÊTIÈRE U

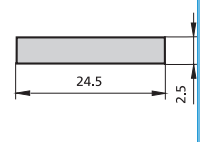

FLAT FRONT PLATE / TÊTIÈRE LISSE

**DESCRIPTION**

REF. RÉF.	MEASUREMENTS DIMENSIONS	CAM CAME	FINISH FINITIONS	UNITS PIÈCES
	B A		FRONT PLATE TÊTIÈRE	CYLINDER CYLINDRE

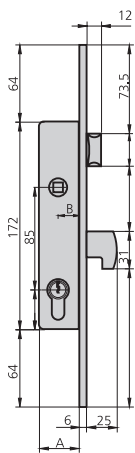

U-SHAPED FRONT PLATE / TÊTIÈRE U

- Latch bolt and dead bolt  
*Demi-tour et pêne*
- Cylinder 5982/2525/4  
*Cylindre 5982/2525/4*
- Strike plate CE1994/6  
*Gâche CE1994/6*
- Security escutcheon  
BT194/1N  
*Plaque de sécurité BT194/1N*

1994/25/6	18	33	15	Al	CN	1	10		
1994/30/6	23	38	15	Al	CN	1	10		
1994/35/6	28	43	15	Al	CN	1	10		

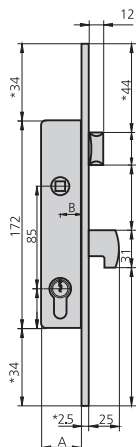

FLAT FRONT PLATE / TÊTIÈRE LISSE

- Latch bolt and dead bolt  
*Demi-tour et pêne*
- Cylinder 5982/2525/4  
*Cylindre 5982/2525/4*
- Strike plate CE1994/6  
*Gâche CE1994/6*
- Security escutcheon  
BT194/1N  
*Plaque de sécurité BT194/1N*

1994/25/6L	22	37	15	Al	CN	1	20		
1994/30/6L	27	42	15	Al	CN	1	20		
1994/35/6L	32	47	15	Al	CN	1	20		







**HOOK DEAD BOLT, 85 mm BETWEEN AXES, DOUBLE EUROPEAN PROFILE CYLINDER /  
PÊNE À CROCHET ENTRE AXES 85 CYLINDRE EUROPROFIL**

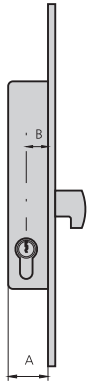





**1994 SERIES / SÉRIE 1994**

METAL WORK  
MENUISERIE MÉTALLIQUE







DESCRIPTION	REF. RÉF.	MEASUREMENTS DIMENSIONS		CAM CAME	FINISH FINITIONS		UNITS PIÈCES			
		B	A		FRONT PLATE TÊTIÈRE	CYLINDER CYLINDRE				

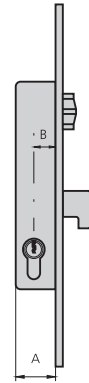







<ul style="list-style-type: none"> <li>• Dead bolt only <i>Pêne uniquement</i></li> <li>• Cylinder 5982/2525/4 <i>Cylindre 5982/2525/4</i></li> <li>• Strike plate CE1994/6 <i>Gâche CE1994/6</i></li> <li>• Security escutcheon BTI94/1N <i>Plaque de sécurité BTI94/1N</i></li> </ul>	<b>U-SHAPED FRONT PLATE / TÊTIÈRE U</b>	1994A25/6	18	33	15	Al	CN	1	10		
		1994A30/6	23	38	15	Al	CN	1	10		
		1994A35/6	28	43	15	Al	CN	1	10		

<ul style="list-style-type: none"> <li>• Dead bolt only <i>Pêne uniquement</i></li> <li>• Cylinder 5982/2525/4 <i>Cylindre 5982/2525/4</i></li> <li>• Strike plate CE1994/6 <i>Gâche CE1994/6</i></li> <li>• Security escutcheon BTI94/1N <i>Plaque de sécurité BTI94/1N</i></li> </ul>	<b>FLAT FRONT PLATE / TÊTIÈRE LISSE</b>	1994A25/6L	22	37	15	Al	CN	1	20		
		1994A30/6L	27	42	15	Al	CN	1	20		
		1994A35/6L	32	47	15	Al	CN	1	20		



<ul style="list-style-type: none"> <li>• Adjustable roller and dead bolt <i>Rouleau réglable et pêne</i></li> <li>• Cylinder 5982/2525/4 <i>Cylindre 5982/2525/4</i></li> <li>• Strike plate CE1994/6 <i>Gâche CE1994/6</i></li> <li>• Security escutcheon BTI94/1N <i>Plaque de sécurité BTI94/1N</i></li> </ul>	<b>U-SHAPED FRONT PLATE / TÊTIÈRE U</b>	1994V25/6	18	33	15	Al	CN	1	10		
		1994V30/6	23	38	15	Al	CN	1	10		
		1994V35/6	28	43	15	Al	CN	1	10		

<ul style="list-style-type: none"> <li>• Adjustable roller and dead bolt <i>Rouleau va-et-vient réglable et pêne</i></li> <li>• Cylinder 5982/2525/4 <i>Cylindre 5982/2525/4</i></li> <li>• Strike plate CE1994/6 <i>Gâche CE1994/6</i></li> <li>• Security escutcheon BTI94/1N <i>Plaque de sécurité BTI94/1N</i></li> </ul>	<b>FLAT FRONT PLATE / TÊTIÈRE LISSE</b>	1994V25/6L	22	37	15	Al	CN	1	20		
		1994V30/6L	27	42	15	Al	CN	1	20		
		1994V35/6L	32	47	15	Al	CN	1	20		

**MULTIPOINT HOOK DEAD BOLT, 85 mm BETWEEN AXES /**  
**PÈNE A CROCHET MULTIPOINT ENTRE AXES 85**

**2994 SERIES / SÉRIE 2994**

**CHARACTERISTICS /**  
**CARACTÉRISTIQUES**

**OPTIONAL ACCESSORIES /**  
**ACCESSOIRES OPTIONNELS**

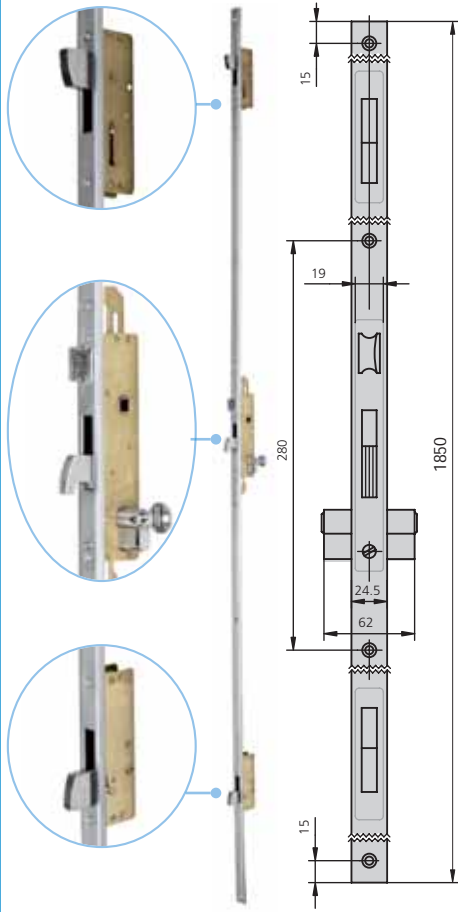

- Stainless steel front plate  
*Têtière en acier inoxydable*
- Bichromate treated sides  
*Boîtier bichromé*
- Tilting hook dead bolt  
*Pêne basculant à crochet*
- Reversible latch bolt  
*Demi-tour réversible*
- 8mm square ruler / Carré de 8mm
- Double security european profile cylinder  
*Cylindre europrofil de sécurité*
- Cylinder set screw  
*Vis de fixation de cylindre*
- Strike plate for given locks  
*Gâche selon serrure*
- Security escutcheon BT194/1N  
*Plaque de sécurité BT194/1N*

- Complete range of cylinders  
*Gamme complète de cylindres*  
(See page / voir page 111-120)

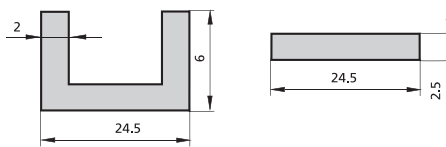

**U-SHAPED FRONT PLATE / TÊTIÈRE U**

**FLAT FRONT PLATE / TÊTIÈRE LISSE**

DESCRIPTION	REF. RÉF.	MEASUREMENTS DIMENSIONS		CAM CAME	FINISH FINITIONS		UNITS PIÈCES	
		B	A		FRONT PLATE TÊTIÈRE	CYLINDER CYLINDRE		

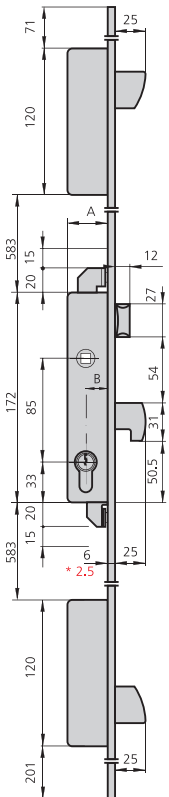

<b>U-SHAPED FRONT PLATE / TÊTIÈRE U</b>	• Latch bolt and dead bolt <i>Demi-tour et pêne</i>	2994/25/6	18	33	15	Al	CN	1		
	• Cylinder 6982/2525/4 <i>Cylindre 6982/2525/4</i>	2994/30/6	23	38	15	Al	CN	1		
	• Strike plate CE1994/6 <i>Gâche CE1994/6</i>	2994/35/6	28	43	15	Al	CN	1		
<b>FLAT FRONT PLATE / TÊTIÈRE LISSE</b>	• High/low strike plate CE2994S/6 <i>Gâche haut/bas CE2994S/6</i>									
	• Security escutcheon BT194/1N <i>Plaque de sécurité BT194/1N</i>									
	• Latch bolt and dead bolt <i>Pêne et demi-tour</i>	2994/25/6L	22	37	15	Al	CN	1		
	• Cylinder 6982/2525/4 <i>Cylindre 6982/2525/4</i>	2994/30/6L	27	42	15	Al	CN	1		
	• Strike plate CE1994/6 <i>Gâche CE1994/6</i>	2994/35/6L	32	47	15	Al	CN	1		
	• High/low strike plate CE2994S/6 <i>Gâche haut/bas CE2994S/6</i>									
• Security escutcheon BT194/1N <i>Plaque de sécurité BT194/1N</i>										

\* Flat front plate measurements / Mesures sur têtière lisse

**MULTIPOINT HOOK DEAD BOLT, 85 mm BETWEEN AXES /  
PÈNE A CROCHET MULTIPOINT ENTRE AXES 85**

**2994 SERIES / SÉRIE 2994**

METAL WORK  
MENUISERIE MÉTALLIQUE

DESCRIPTION	REF. RÉF.	MEASUREMENTS DIMENSIONS		CAM CAME	FINISH FINITIONS		UNITS PIÈCES			
		B	A		FRONT PLATE TÊTIÈRE	CYLINDER CYLINDRE				

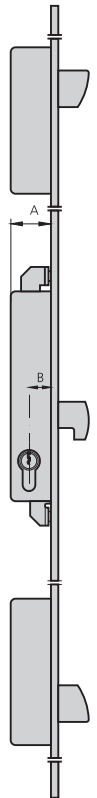

U-SHAPED FRONT PLATE / TÊTIÈRE U

- Dead bolt only  
*Pêne uniquement*
- Cylinder 6982/2525/4  
*Cylindre 6982/2525/4*
- Strike plate CE1994/6  
*Gâche CE1994/6*
- High/low strike plate CE2994S/6  
*Gâche haut/bas CE2994S/6*
- Security escutcheon BT194/1N  
*Plaque de sécurité BT194/1N*

2994A25/6	18	33	15	Al	CN	1		
2994A30/6	23	38	15	Al	CN	1		
2994A35/6	28	43	15	Al	CN	1		

FLAT FRONT PLATE / TÊTIÈRE LISSE

- Dead bolt only  
*Pêne uniquement*
- Cylinder 6982/2525/4  
*Cylindre 6982/2525/4*
- Strike plate CE1994/6  
*Gâche CE1994/6*
- High/low strike plate CE2994S/6  
*Gâche haut/bas CE2994S/6*
- Security escutcheon BT194/1N  
*Plaque de sécurité BT194/1N*

2994A25/6L	22	37	15	Al	CN	1		
2994A30/6L	27	42	15	Al	CN	1		
2994A35/6L	32	47	15	Al	CN	1		

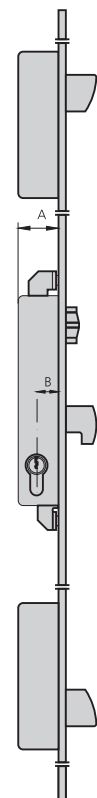

U-SHAPED FRONT PLATE / TÊTIÈRE U

- Adjustable roller and dead bolt  
*Rouleau réglable et pêne*
- Cylinder 6982/2525/4  
*Cylindre 6982/2525/4*
- Strike plates CE1994/6  
*Gâches CE1994/6*
- High/low strike plates CE2994S/6  
*Gâches haut/bas CE2994S/6*
- Security escutcheon BT194/1N  
*Plaque de sécurité BT194/1N*

2994V25/6	18	33	15	Al	CN	1		
2994V30/6	23	38	15	Al	CN	1		
2994V35/6	28	43	15	Al	CN	1		

FLAT FRONT PLATE / TÊTIÈRE LISSE

- Adjustable roller and dead bolt  
*Rouleau réglable et pêne*
- Cylinder 6982/2525/4  
*Cylindre 6982/2525/4*
- Strike plates CE1994/6  
*Gâches CE1994/6*
- High/low strike plates CE2994S/6  
*Gâches haut/bas CE2994S/6*
- Security escutcheon BT194/1N  
*Plaque de sécurité BT194/1N*

2994V25/6L	22	37	15	Al	CN	1		
2994V30/6L	27	42	15	Al	CN	1		
2994V35/6L	32	47	15	Al	CN	1		

**MULTIPOINT HOOK DEAD BOLT, 85 mm BETWEEN AXES /  
PÊNE A CROCHET MULTIPOINT ENTRE-AXES 85**

**3994 SERIES / SÉRIE 3994**

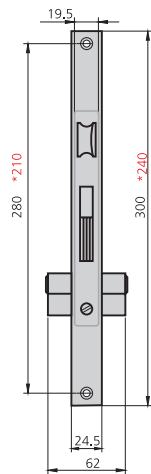

**CHARACTERISTICS /  
CARACTÉRISTIQUES**

- 3 point lock with M8 threaded rod  
*Serrure à 3 points par barre filetée de M8*
- Stainless steel front plate  
*Têtière en acier inoxydable*
- Bichromate treated sides  
*Boîtier bichromé*
- Tilting hook dead bolt / *Pêne basculant à crochet*
- Reversible latch bolt / *Demi-tour réversible*
- 8mm square ruler / *Carré de 8mm*
- Security european profile cylinder  
*Cylindre de sécurité*
- Cylinder set screw  
*Vis de fixation de cylindre*
- Strike plate for given locks  
*Gâche selon serrure*
- Security escutcheon ref. BT194/1N  
*Plaque de sécurité BT194/1N*

**OPTIONAL ACCESSORIES /  
ACCESSOIRES OPTIONNELS**

- Complete range of cylinders  
*Gamme complète de cylindres*  
(See page / voir page 111-120)

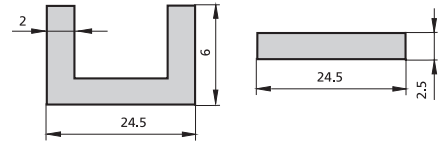

U-SHAPED FRONT PLATE / TÊTIÈRE U

FLAT FRONT PLATE / TÊTIÈRE LISSE

\* Flat front plate measurements / Mesures sur têtière lisse

DESCRIPTION	REF. RÉF.	MEASUREMENTS DIMENSIONS		CAM CAME	FINISH FINITIONS	FRONT PLATE TÊTIÈRE		CYLINDER CYLINDRE		UNITS PIÈCES	
		B	A								
<p><b>U-SHAPED FRONT PLATE / TÊTIÈRE U</b></p> <ul style="list-style-type: none"> <li>• Latch bolt and dead bolt <i>Demi-tour et pêne</i></li> <li>• Cylinder 6982/2525/4 <i>Cylindre 6982/2525/4</i></li> <li>• Strike plate CE1994/6 <i>Gâche CE1994/6</i></li> <li>• Security escutcheon BT194/1N <i>Plaque de sécurité BT194/1N</i></li> </ul>	3994/25/6	18	33	15	Al	CN	1	10			
	3994/30/6	23	38	15	Al	CN	1	10			
	3994/35/6	28	43	15	Al	CN	1	10			
<p><b>FLAT FRONT PLATE / TÊTIÈRE LISSE</b></p> <ul style="list-style-type: none"> <li>• Latch bolt and dead bolt <i>Demi-tour et pêne</i></li> <li>• Cylinder 6982/2525/4 <i>Cylindre 6982/2525/4</i></li> <li>• Strike plate CE1994/6 <i>Gâche CE1994/6</i></li> <li>• Security escutcheon BT194/1N <i>Plaque de sécurité BT194/1N</i></li> </ul>	3994/25/6L	22	37	15	Al	CN	1	10			
	3994/30/6L	27	42	15	Al	CN	1	10			
	3994/35/6L	32	47	15	Al	CN	1	10			

\* Flat front plate measurements / Mesures sur têtière lisse

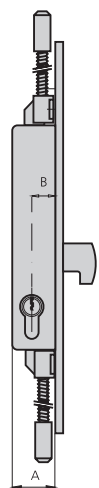



<p><b>U-SHAPED FRONT PLATE / TÊTIÈRE U</b></p> <ul style="list-style-type: none"> <li>• Dead bolt only <i>Pêne uniquement</i></li> <li>• Cylinder 6982/2525/4 <i>Cylindre 6982/2525/4</i></li> <li>• Strike plate CE1994/6 <i>Gâche CE1994/6</i></li> <li>• Security escutcheon BT194/1N <i>Plaque de sécurité BT194/1N</i></li> </ul>	3994A25/6	18	33	15	Al	CN	1	10		
	3994A30/6	23	38	15	Al	CN	1	10		
	3994A35/6	28	43	15	Al	CN	1	10		
<p><b>FLAT FRONT PLATE / TÊTIÈRE LISSE</b></p> <ul style="list-style-type: none"> <li>• Cylinder 6982/2525/4 <i>Cylindre 6982/2525/4</i></li> <li>• Strike plate CE1994/6 <i>Gâche CE1994/6</i></li> <li>• Security escutcheon BT194/1N <i>Plaque de sécurité BT194/1N</i></li> </ul>	3994A25/6L	22	37	15	Al	CN	1	10		
	3994A30/6L	27	42	15	Al	CN	1	10		
	3994A35/6L	32	47	15	Al	CN	1	10		

**MULTIPOINT HOOK DEAD BOLT, 85 mm BETWEEN AXES /  
PÊNE A CROCHET MULTIPOINT ENTRE-AXES 85**

**3994 SERIES / SÉRIE 3994**

METAL WORK  
MENUISERIE MÉTALLIQUE

DESCRIPTION	REF. RÉF.	MEASUREMENTS DIMENSIONS		CAM CAME	FINISH FINITIONS		UNITS PIÈCES			
		B	A		FRONT PLATE TÊTIÈRE	CYLINDER CYLINDRE				

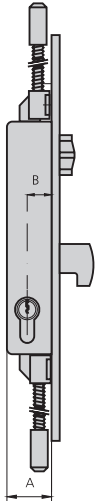

U-SHAPED FRONT PLATE / TÊTIÈRE U

- Adjustable roller and dead bolt  
*Rouleau réglable et pêne*
- Cylinder 6982/2525/4  
*Cylindre 6982/2525/4*
- Strike plate CE1994/6  
*Gâche CE1994/6*
- Security escutcheon BT194/1N  
*Plaque de sécurité BT194/1N*

3994V25/6	18	33	15	Al	CN	1	10		
3994V30/6	23	38	15	Al	CN	1	10		
3994V35/6	28	43	15	Al	CN	1	10		

FLAT FRONT PLATE / TÊTIÈRE LISSE

- Adjustable roller and dead bolt  
*Rouleau réglable et pêne*
- Cylinder 6982/2525/4  
*Cylindre 6982/2525/4*
- Strike plate CE1994/6  
*Gâche CE1994/6*
- Security escutcheon BT194/1N  
*Plaque de sécurité BT194/1N*

3994V25/6L	22	37	15	Al	CN	1	10		
3994V30/6L	27	42	15	Al	CN	1	10		
3994V35/6L	32	47	15	Al	CN	1	10		

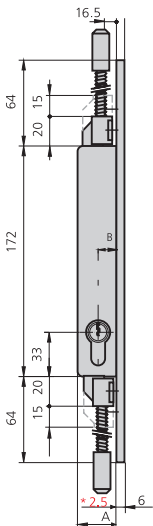

U-SHAPED FRONT PLATE / TÊTIÈRE U

- Without latch bolt and dead bolt  
*Sans demi-tour et pêne*
- Cylinder 6982/2525/4  
*Cylindre 6982/2525/4*
- Security escutcheon BT194/1N  
*Plaque de sécurité BT194/1N*

3994F25/6	18	33	15	Al	CN	1	10		
3994F30/6	23	38	15	Al	CN	1	10		
3994F35/6	28	43	15	Al	CN	1	10		

FLAT FRONT PLATE / TÊTIÈRE LISSE

- Without latch bolt and dead bolt  
*Sans demi-tour et pêne*
- Cylinder 6982/2525/4  
*Cylindre 6982/2525/4*
- Security escutcheon BT194/1N  
*Plaque de sécurité BT194/1N*

3994F25/6L	22	37	15	Al	CN	1	10		
3994F30/6L	27	42	15	Al	CN	1	10		
3994F35/6L	32	47	15	Al	CN	1	10		

**MULTIPOINT HOOK DEAD BOLT, 85 mm BETWEEN AXES /  
PÈNE A CROCHET MULTIPOINT ENTRE-AXES 85**

**4994 SERIES / SÉRIE 4994**

**CHARACTERISTICS /  
CARACTÉRISTIQUES**

**OPTIONAL ACCESSORIES /  
ACCESSOIRES OPTIONELS**

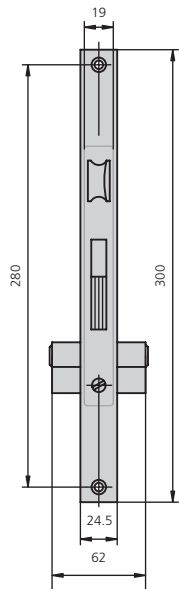

- 3 point lock with M8 perforated rod  
*Serrure à 3 points par barre perforée*
- Stainless steel front plate  
*Têtière en acier inoxydable*
- Bichromate treated sides  
*Boîtier bichromé*
- Tilting hook dead bolt  
*Pêne basculant à crochet*
- Reversible latch bolt / *Demi-tour réversible*
- 8mm square ruler / *Carré de 8mm*
- Security european profile cylinder  
*Cylindre de sécurité*
- Cylinder set screw  
*Vis de fixation de cylindre*
- Strike plate for given locks  
*Gâche selon serrure*
- Security escutcheon ref. BT194/1N  
*Plaque de sécurité BT194/1N*

- Complete range of cylinders  
*Gamme complète de cylindres*  
(See page / voir page 111-120)

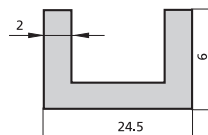

**U-SHAPED FRONT PLATE / TÊTIÈRE U**

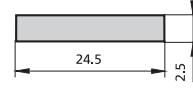

**FLAT FRONT PLATE / TÊTIÈRE LISSE**

\* Flat front plate measurements / Mesures sur têtière lisse

DESCRIPTION	REF. RÉF.	MEASUREMENTS DIMENSIONS		CAM CAME	FINISH FINITIONS	UNITS PIÈCES			
		B	A			FRONT PLATE TÊTIÈRE	CYLINDER CYLINDRE		

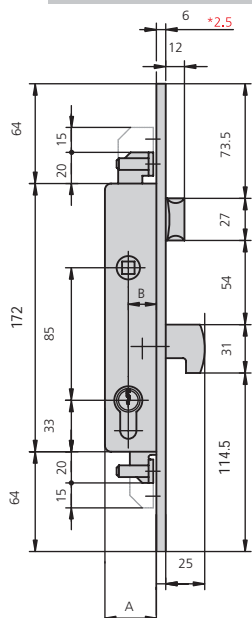

- U-SHAPED FRONT PLATE / TÊTIÈRE U**
- Latch bolt and dead bolt  
*Demi-tour et pêne*
  - Cylinder 6982/2525/4  
*Cylindre 6982/2525/4*
  - Strike plate CE1994/6  
*Gâche CE1994/6*
  - Security escutcheon BT194/1N  
*Plaque de sécurité BT194/1N*

4994/25/6	18	33	15	Al	CN	1	10		
4994/30/6	23	38	15	Al	CN	1	10		
4994/35/6	28	43	15	Al	CN	1	10		

- FLAT FRONT PLATE / TÊTIÈRE LISSE**
- Latch bolt and dead bolt  
*Demi-tour et pêne*
  - Cylinder 6982/2525/4  
*Cylindre 6982/2525/4*
  - Strike plate CE1994/6  
*Gâche CE1994/6*
  - Security escutcheon BT194/1N  
*Plaque de sécurité BT194/1N*

4994/25/6L	22	37	15	Al	CN	1	10		
4994/30/6L	27	42	15	Al	CN	1	10		
4994/35/6L	32	47	15	Al	CN	1	10		

\* Flat front plate measurements / Mesures sur têtière lisse

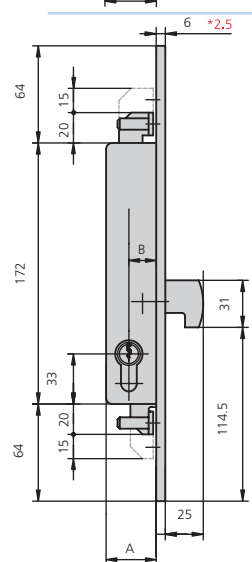

- U-SHAPED FRONT PLATE / TÊTIÈRE U**
- Dead bolt only  
*Pêne uniquement*
  - Cylinder 6982/2525/4  
*Cylindre 6982/2525/4*
  - Strike plate CE1994/6  
*Gâche CE1994/6*
  - Security escutcheon BT194/1N  
*Plaque de sécurité BT194/1N*

4994A25/6	18	33	15	Al	CN	1	10		
4994A30/6	23	38	15	Al	CN	1	10		
4994A35/6	28	43	15	Al	CN	1	10		

- FLAT FRONT PLATE / TÊTIÈRE LISSE**
- Dead bolt only  
*Pêne uniquement*
  - Cylinder 6982/2525/4  
*Cylindre 6982/2525/4*
  - Strike plate CE1994/6  
*Gâche CE1994/6*
  - Security escutcheon BT194/1N  
*Plaque de sécurité BT194/1N*

4994A25/6L	22	37	15	Al	CN	1	10		
4994A30/6L	27	42	15	Al	CN	1	10		
4994A35/6L	32	47	15	Al	CN	1	10		

\* Flat front plate measurements / Mesures sur têtière lisse

**MULTIPOINT HOOK DEAD BOLT, 85 mm BETWEEN AXES /  
PÊNE A CROCHET MULTIPOINT ENTRE-AXES 85**

**4994 SERIES / SÉRIE 4994**

METAL WORK  
MENUISERIE MÉTALLIQUE

DESCRIPTION	REF. RÉF.	MEASUREMENTS DIMENSIONS		CAM CAME	FINISH FINITIONS		UNITS PIÈCES			
		B	A		FRONT PLATE	CYLINDER	1	10		
					TÊTIÈRE	CYLINDRE				

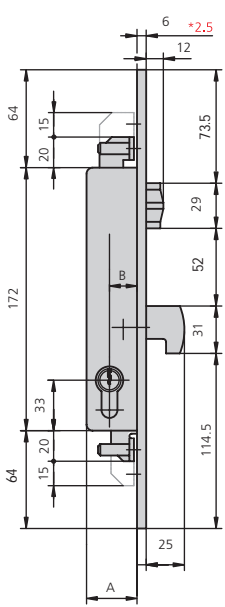

- Adjustable roller and dead bolt  
*Rouleau réglable et pêne*
- Cylinder 6982/2525/4  
*Cylindre 6982/2525/4*
- Strike plate CE1994/6  
*Gâche CE1994/6*
- Security escutcheon BT194/1N  
*Plaque de sécurité BT194/1N*

4994V25/6	18	33	15	Al	CN	1	10		
4994V30/6	23	38	15	Al	CN	1	10		
4994V35/6	28	43	15	Al	CN	1	10		

- Adjustable roller and dead bolt  
*Rouleau réglable et pêne*
- Cylinder 6982/2525/4  
*Cylindre 6982/2525/4*
- Strike plate CE1994/6  
*Gâche CE1994/6*
- Security escutcheon BT194/1N  
*Plaque de sécurité BT194/1N*

4994V25/6L	22	37	15	Al	CN	1	10		
4994V30/6L	27	42	15	Al	CN	1	10		
4994V35/6L	32	47	15	Al	CN	1	10		

\* Flat front plate measurements / Mesures sur tête lisse

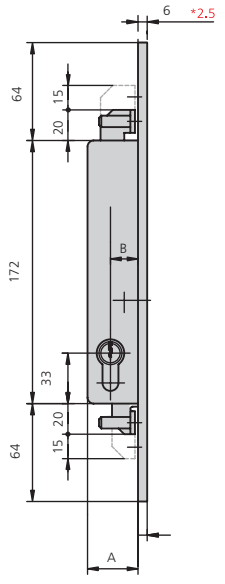

- Without latch bolt and dead bolt  
*Avec demi-tour et pêne*
- Cylinder 6982/2525/4  
*Cylindre 6982/2525/4*
- Security escutcheon BT194/1N  
*Plaque de sécurité BT194/1N*

4994F25/6	18	33	15	Al	CN	1	10		
4994F30/6	23	38	15	Al	CN	1	10		
4994F35/6	28	43	15	Al	CN	1	10		

- Without latch bolt and dead bolt  
*Avec demi-tour et pêne*
- Cylinder 6982/2525/4  
*Cylindre 6982/2525/4*
- Strike plate CE1994/6  
*Gâche CE1994/6*
- Security escutcheon BT194/1N  
*Plaque de sécurité BT194/1N*

4994F25/6L	22	37	15	Al	CN	1	10		
4994F30/6L	27	42	15	Al	CN	1	10		
4994F35/6L	32	47	15	Al	CN	1	10		

\* Flat front plate measurements / Mesures sur tête lisse

**SLIDING DEAD BOLT, 92 mm BETWEEN AXES, DOUBLE EUROPEAN PROFILE CYLINDER / PÈNE COULISSANT ENTRE AXES 92 CYLINDRE EUROPROFIL**

**1992 SERIES / SÉRIE 1992**

**CHARACTERISTICS / CARACTÉRISTIQUES**

**OPTIONAL ACCESSORIES / ACCESSOIRES OPTIONELS**

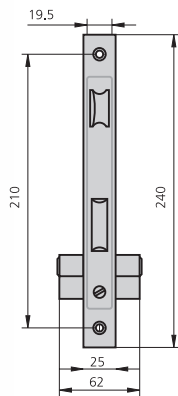

- Stainless steel front plate  
*Têtière en acier inoxydable*
- Bichromate treated sides  
*Boîtier bichromé*
- Sliding dead bolt / Pêne coulissant
- Reversible latch bolt  
*Demi-tour réversible*
- 8mm square ruler / Carré de 8mm
- Double european profile cylinder  
*Cylindre europrofil*
- 2 nylon escutcheons ref. ES1984  
*2 plaques en nylon réf. ES1984*
- Cylinder set screw  
*Vis de fixation de cylindre*

- Strike plates for given locks  
*Gâches selon serrure*  
(See below / voir ci-dessous)
- Complete range of cylinders  
*Gamme complète de cylindres*  
(See page / voir page 111-120)

DESCRIPTION	REF. RÉF.	MEASUREMENTS DIMENSIONS		CAM CAME	FINISH FINITIONS		UNITS PIÈCES			
		B	A		FRONT PLATE TÊTIÈRE	CYLINDER CYLINDRE				

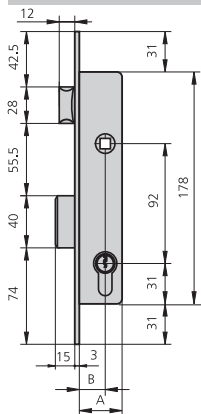

- Latch bolt and dead bolt  
*Demi-tour et pêne*
- Cylinder 5990/2525/4  
*Cylindre 5990/2525/4*

1992/20/6	20	33	13,25	Al	CN	1	20		
1992/25/6	25	38	13,25	Al	CN	1	20		
1992/30/6	30	43	13,25	Al	CN	1	20		

- Strike plate options**  
*Options de gâche*
- CE1984/6

- Electric strike plate option**  
*Option gâche électrique*
- CELC196/6A or /ou CELC196/6AD

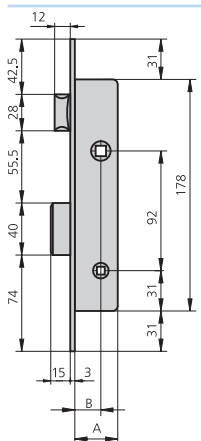

- Lock with dead bolt  
*Serrure de condamnation*
- Without cylinder  
*Sans cylindre*

1992C20/6	20	33		Al		2	40		
1992C25/6	25	38		Al		2	40		
1992C30/6	30	43		Al		2	40		

- Strike plate options**  
*Options de gâche*
- CE1984/6

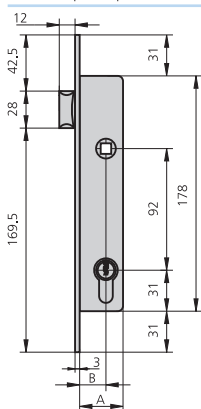

- Latch bolt only  
*Demi-tour uniquement*
- Cylinder 5982T40/4  
*Cylindre 5982T40/4*

1992T20/6	20	33	15	Al	CN	1	20		
1992T25/6	25	38	15	Al	CN	1	20		
1992T30/6	30	43	15	Al	CN	1	20		

- Electric strike plate option**  
*Option gâche électrique*
- CELC196T/6A or /ou CELC196T/6AD

**SLIDING DEAD BOLT, 70 mm BETWEEN AXES, DOUBLE EUROPEAN PROFILE CYLINDER /  
PÈNE COULISSANT ENTRE AXES 70 CYLINDRE EUROPROFIL**

**1983 SERIES / SÉRIE 1983**

**CHARACTERISTICS /  
CARACTÉRISTIQUES**

**OPTIONAL ACCESSORIES /  
ACCESSOIRES OPTIONNELS**

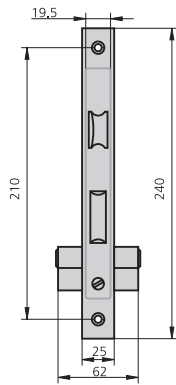

- Nickel plated iron or stainless steel face plate  
*Têtière en fer nickelé ou acier inoxydable*
- Bichromate treated sides / *Boîtier bichromé*
- Sliding dead bolt / *Pêne coulissant*
- Reversible latch bolt / *Demi-tour réversible*
- 8mm square ruler / *Carré de 8mm*
- Double european profile cylinder  
*Cylindre europrofil*
- 2 nylon escutcheons ref. ES1984  
*2 plaques en nylon réf. ES1984*
- Cylinder set screw  
*Vis de fixation de cylindre*

- Strike plates for given locks  
*Gâches selon serrure*  
(See below / voir ci-dessous)
- Complete range of cylinders  
*Gamme complète de cylindres*  
(See page / voir page 111-120)

**DESCRIPTION**

**REF.  
RÉF.**

**MEASUREMENTS  
DIMENSIONS**

**CAM  
CAME**

**FINISH  
FINITIONS**

**UNITS  
PIÈCES**

**FRONT PLATE CYLINDER  
TÊTIÈRE CYLINDRE**

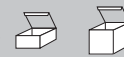

**B A**

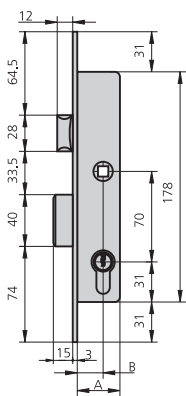

- Latch bolt and dead bolt  
*Demi-tour et pêne*
- Cylinder 5990/2525  
*Cylindre 5990/2525*
- Strike plate options**  
*Options de gâche*
- CE1983/0 or /ou CE1983/6

REF. RÉF.	B	A	CAM CAME	FINISH FINITIONS	UNITS PIÈCES		
1983/20/0	20	33	13,25	HN CN	1 20		
1983/20/5	20	33	13,25	HN CL	1 20		
1983/20/6	20	33	13,25	Al CN	1 20		
1983/25/0	25	38	13,25	HN CN	1 20		
1983/25/5	25	38	13,25	HN CL	1 20		
1983/25/6	25	38	13,25	Al CN	1 20		
1983/30/0	30	43	13,25	HN CN	1 20		
1983/30/5	30	43	13,25	HN CL	1 20		
1983/30/6	30	43	13,25	Al CN	1 20		

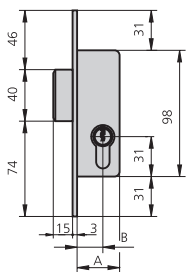

- Dead bolt only  
*Pêne uniquement*
- Cylinder 5990/2525  
*Cylindre 5990/2525*
- Strike plate options**  
*Options de gâche*
- CE2994S/6

REF. RÉF.	B	A	CAM CAME	FINISH FINITIONS	UNITS PIÈCES		
1983A20/0	20	33	13,25	HN CN	1 30		
1983A20/5	20	33	13,25	HN CL	1 30		
1983A25/0	20	33	13,25	HN CN	1 30		
1983A25/5	20	33	13,25	HN CL	1 30		
1983A30/0	20	33	13,25	HN CN	1 30		
1983A30/5	20	33	13,25	HN CL	1 30		

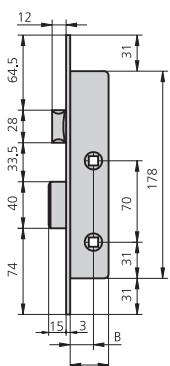

- Lock with dead bolt  
*Serrure de condamnation*
- Without cylinder  
*Sans cylindre*
- Strike plate options**  
*Options de gâche*
- CE1983/6

REF. RÉF.	B	A	CAM CAME	FINISH FINITIONS	UNITS PIÈCES		
1983C20/6	20	33		Al	2 40		
1983C25/6	25	38		Al	2 40		
1983C30/6	30	43		Al	2 40		

**SLIDING DEAD BOLT, 70 mm BETWEEN AXES, DOUBLE CYLINDER /  
PÊNE COULISSANT ENTRE AXES 70 CYLINDRE EUROPROFIL**

**1983 SERIES / SÉRIE 1983**

DESCRIPTION	REF. RÉF.	MEASUREMENTS DIMENSIONS		CAM CAME	FINISH FINITIONS		UNITS PIÈCES			
		B	A		FRONT PLATE TÊTIÈRE	CYLINDER CYLINDRE				
<ul style="list-style-type: none"> <li>Lock with latch bolt only <i>Serrure à pêne uniquement</i></li> <li>Without cylinder <i>Sans cylindre</i></li> </ul>	1983R20/0	20	33		HN		2	60		
	1983R25/0	25	38		HN		2	60		
	1983R30/0	30	43		HN		2	60		

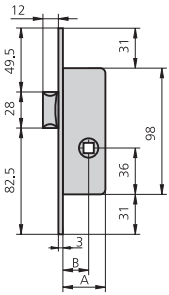

<ul style="list-style-type: none"> <li>Lock with roller only <i>Serrure à rouleau uniquement</i></li> <li>Without cylinder <i>Sans cylindre</i></li> </ul>	1983RV/0		33		HN		2	60		
--	----------	--	----	--	----	--	---	----	--	--

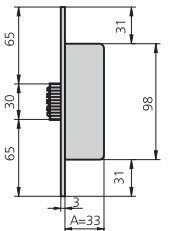

<ul style="list-style-type: none"> <li>Latch bolt only <i>Demi-tour uniquement</i></li> <li>Cylinder 5982T40/4 <i>Cylindre 5982T40/4</i></li> </ul>	1983T20/6	20	33	15	Al	CN	1	20		
	1983T25/6	25	38	15	Al	CN	1	20		
	1983T30/6	30	43	15	Al	CN	1	20		

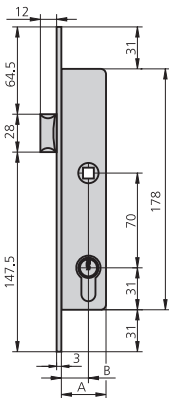

**Electric strike plate option  
Option gâche électrique**

- CELC196T/6A or / ou CELC196T/6AD

**SLIDING DEAD BOLT, 85 mm BETWEEN AXES, MONOBLOCK OVAL CYLINDER /  
PÊNE COULISSANT ENTRE-AXES 85 CYLINDRE OVALE MONOBLOC**

**1963 SERIES / SÉRIE 1963**

**CHARACTERISTICS /  
CARACTÉRISTIQUES**

**OPTIONAL ACCESSORIES /  
ACCESSOIRES OPTIONELS**

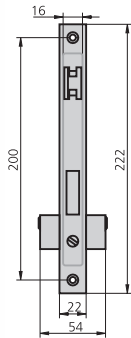

- Nickel plated iron or stainless steel face plate  
*Têtière en fer nickelé ou acier inoxydable*
- Bichromate treated sides / *Boîtier bichromé*
- Sliding dead bolt / *Pêne coulissant*
- Reversible latch bolt / *Demi-tour réversible*
- 8mm square ruler / *Carré de 8mm*
- Monoblock oval cylinder (5963)  
*Cylindre ovale monoblock (5963)*
- 2 nylon escutcheons ref. ES1963  
*2 plaques en nylon réf. ES1963*
- Cylinder set screw  
*Vis de fixation de cylindre*

- Strike plates for given locks  
*Gâches selon serrure*  
(See below / *voir ci-dessous*)
- Cylinders / *Cylindres*  
(See below / *voir ci-dessous 121*)

DESCRIPTION	REF. RÉF.	MEASUREMENTS DIMENSIONS		CAM CAME	FINISH FINITIONS		UNITS PIÈCES			
		B	A		FRONT PLATE TÊTIÈRE	CYLINDER CYLINDRE				

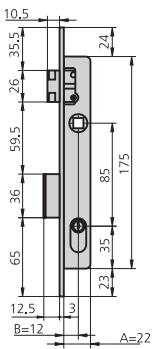

- Latch bolt and dead bolt  
*Demi-tour et pêne*
- Cylinder 5963/2222  
*Cylindre 5963/2222*

1963/0	12	22	HN	CN	1	20		
1963/5	12	22	HN	CL	1	20		
1963/6	12	22	AI	CN	1	20		

- Strike plate options**  
*Options de gâche*
- CE1984/0 or / ou CE1984/6

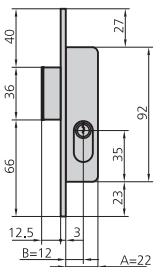

- Lock with dead bolt only  
*Serrure à pêne uniquement*
- Cylinder 5963/2222  
*Cylindre 5963/2222*

1963A/0	12	22	HN	CN	1	30		
1963A/5	12	22	HN	CL	1	30		
1963A/6	12	22	AI	CN	1	30		

- Strike plate options**  
*Options de gâche*
- CE2994S/6

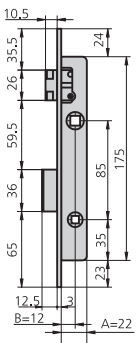

- Lock with dead bolt  
*Serrure de condamnation*
- Without cylinder  
*Sans cylindre*

1963C/6	12	22	AI		2	40		
---------	----	----	----	--	---	----	--	--

- Strike plate options**  
*Options de gâche*
- CE1984/6

**SLIDING DEAD BOLT, 85 mm BETWEEN AXES, MONOBLOCK OVAL CYLINDER /**  
**PÊNE COULISSANT ENTRE-AXES 85 CYLINDRE OVALE MONOBLOC** **1963 SERIES / SÉRIE 1963**

DESCRIPTION	REF. RÉF.	MEASUREMENTS DIMENSIONS		CAM CAME	FINISH FINITIONS		UNITS PIÈCES			
		B	A		FRONT PLATE TÊTIÈRE	CYLINDER CYLINDRE				

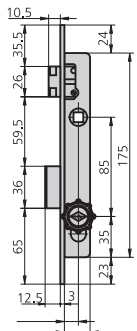

- Lock with dead bolt knob  
*Serrure avec bouton de condamnation*
- Without cylinder  
*Sans cylindre*

**Strike plate options**  
*Options de gâche*

- CE1984/6

1963CP16/6	12	22	Al	1	20		
------------	----	----	----	---	----	--	--

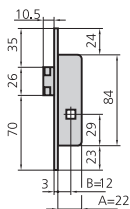

- Lock with latch bolt only  
*Serrure de demi-tour uniquement*
- Without cylinder  
*Sans cylindre*

**Strike plate options**  
*Options de gâche*

- CE196R/6

1963R/0	12	22	HN	2	60		
---------	----	----	----	---	----	--	--

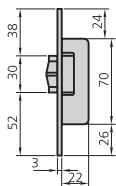

- Lock with roller only  
*Serrure de rouleau uniquement*
- Without cylinder  
*Sans cylindre*

**Strike plate options**  
*Options de gâche*

- CE196R/6

1963RV/0		22	HN	2	60		
----------	--	----	----	---	----	--	--

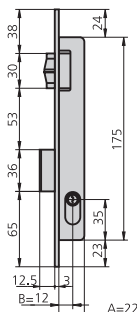

- Adjustable roller and dead bolt  
*Rouleau réglable et pêne*
- Cylinder 5963/2222  
*Cylindre 5990/2525*

**Strike plate options**  
*Options de gâche*

- CE1984/0 or / ou CE1984/6

1963V/0	12	22	HN	CN	1	20		
1963V/5	12	22	HN	CL	1	20		
1963V/6	12	22	Al	CN	1	20		

**SLIDING DEAD BOLT, 85 mm BETWEEN AXES, MONOBLOCK OVAL CYLINDER /  
PÈNE COULISSANT ENTRE-AXES 85 CYLINDRE OVALE MONOBLOC**

**1975 SERIES / SÉRIE 1975**

**CHARACTERISTICS /  
CARACTÉRISTIQUES**

**OPTIONAL ACCESSORIES /  
ACCESSOIRES OPTIONELS**

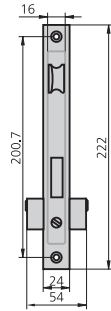

- Nickel plated iron front plate  
*Têtière en fer nickelé*
- Bichromate treated sides / *Boîtier bichromé*
- Sliding dead bolt / *Pêne coulissant*
- Reversible latch bolt / *Demi-tour réversible*
- 8mm square ruler / *Carré de 8mm*
- Monoblock oval cylinder (5963)  
*Cylindre ovale monoblock (5963)*
- 2 nylon escutcheons ref. ES1963  
*2 plaques en nylon réf. ES1963*
- Cylinder set screw  
*Vis de fixation de cylindre*

- Strike plates for given locks  
*Gâches selon serrure*  
(See below / *voir ci-dessous*)
- Cylinders / *Cylindres*  
(See below / *voir ci-dessous 121*)

DESCRIPTION	REF. RÉF.	MEASUREMENTS DIMENSIONS		CAM CAME	FINISH FINITIONS		UNITS PIÈCES			
		B	A		FRONT PLATE TÊTIÈRE	CYLINDER CYLINDRE				
<ul style="list-style-type: none"> <li>• Latch bolt and dead bolt <i>Demi-tour et pêne</i></li> <li>• Cylinder 5963/2222 <i>Cylindre 5963/2222</i></li> </ul> <p><b>Strike plate options</b> <i>Options de gâche</i></p> <ul style="list-style-type: none"> <li>• CE1984/0</li> </ul>	1975/0	17	34		HN	CN	1	20		
	1975/5	17	34		HN	CL	1	20		
<ul style="list-style-type: none"> <li>• Lock with dead bolt only <i>Serrure à pêne uniquement</i></li> <li>• Cylinder 5963/2222 <i>Cylindre 5963/2222</i></li> </ul> <p><b>Strike plate options</b> <i>Options de gâche</i></p> <ul style="list-style-type: none"> <li>• CE2994S/6</li> </ul>	1975A/0	17	34		HN	CN	1	30		
	1975A/5	17	34		HN	CL	1	30		
<ul style="list-style-type: none"> <li>• Lock with latch bolt only <i>Serrure avec demi-tour uniquement</i></li> <li>• Cylinder 5963T36 <i>Cylindre 5963T36</i></li> </ul> <p><b>Electric strike plate option</b> <i>Option gâche électrique</i></p> <ul style="list-style-type: none"> <li>• CELC196T/6A or / ou CELC196T/6AD</li> </ul>	1975T/0	17	34		HN	CN	1	20		
	1975T/5	17	34		HN	CL	1	20		
<ul style="list-style-type: none"> <li>• Adjustable roller and dead bolt <i>Rouleau réglable et pêne</i></li> <li>• Cylinder 5963/2222 <i>Cylindre 5963/2222</i></li> </ul> <p><b>Strike plate options</b> <i>Options de gâche</i></p> <ul style="list-style-type: none"> <li>• CE1984/0</li> </ul>	1975V/0	17	34		HN	CN	1	20		
	1975V/5	17	34		HN	CL	1	20		

**SLIDING DEAD BOLT, 85 mm BETWEEN AXES, OVAL CYLINDER /  
PÈNE COULISSANT ENTRE AXES 85 CYLINDRE OVALE À TIGES**

**1964 SERIES / SÉRIE 1964**

**CHARACTERISTICS /  
CARACTÉRISTIQUES**

**OPTIONAL ACCESSORIES /  
ACCESSOIRES OPTIONNELS**

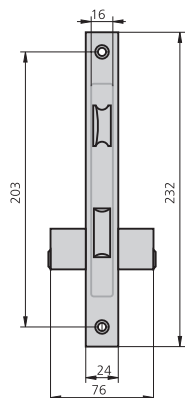



- Nickel plated iron or stainless steel face plate  
*Têtière en fer nickelé ou acier inoxydable*
- Bichromate treated sides / *Boîtier bichromé*
- Sliding dead bolt / *Pêne coulissant*
- Reversible latch bolt / *Demi-tour réversible*
- 8mm square ruler / *Carré de 8mm*
- Monoblock oval cylinder (5964)  
*Cylindre ovale monobloc (5964)*
- 2 nylon escutcheons ref. ES1964  
*2 plaques en nylon réf. ES1964*
- Cylinder set screw  
*Vis de fixation de cylindre*

- Strike plates for given locks  
*Gâches selon serrure*  
(See below / *voir ci-dessous*)
- Cylinders / *Cylindres*  
(See below / *voir ci-dessous 125*)

DESCRIPTION	REF. RÉF.	MEASUREMENTS DIMENSIONS		CAM CAME	FINISH FINITIONS		UNITS PIÈCES			
		B	A		FRONT PLATE TÊTIÈRE	CYLINDER CYLINDRE				
<ul style="list-style-type: none"> <li>• Latch bolt and dead bolt <i>Demi-tour et pêne</i></li> <li>• Oval cylinder 5964/2525 <i>Cylindre ovale 5924/2525</i></li> </ul> <p><b>Strike plate options</b> <i>Options de gâche</i></p> <ul style="list-style-type: none"> <li>• CE1984/0 or / ou CE1984/6</li> </ul>	1964/0	20	34		HN	CN	1	20		
	1964/5	20	34		HN	CL	1	20		
	1964/6	20	34		Al	CN	1	20		
<ul style="list-style-type: none"> <li>• Lock with dead bolt only <i>Serrure avec pêne uniquement</i></li> <li>• Oval cylinder 5964/2525 <i>Cylindre ovale 5924/2525</i></li> </ul> <p><b>Strike plate options</b> <i>Options de gâche</i></p> <ul style="list-style-type: none"> <li>• CE2994S/6</li> </ul>	1964A/0	20	34		HN	CN	1	30		
	1964A/5	20	34		HN	CL	1	30		
	1964A/6	20	34		Al	CN	1	30		
<ul style="list-style-type: none"> <li>• Lock with dead bolt <i>Serrure à condamnation</i></li> <li>• Without cylinder <i>Sans cylindre</i></li> </ul> <p><b>Strike plate options</b> <i>Options de gâche</i></p> <ul style="list-style-type: none"> <li>• CE1984/0 or / ou CE1984/6</li> </ul>	1964C/0	20	34		HN		2	40		
	1964C/6	20	34		Al		2	40		
<ul style="list-style-type: none"> <li>• Lock with dead bolt knob <i>Serrure avec condamnation à bouton</i></li> <li>• Without cylinder <i>Sans cylindre</i></li> </ul> <p><b>Strike plate options</b> <i>Options de gâche</i></p> <ul style="list-style-type: none"> <li>• CE1984/6</li> </ul>	1964CP/6	20	34		Al		1	20		

**SLIDING DEAD BOLT, 85 mm BETWEEN AXES, OVAL CYLINDER /  
PÈNE COULISSANT ENTRE AXES 85 CYLINDRE OVALE À TIGES**

**1964 SERIES / SÉRIE 1964**

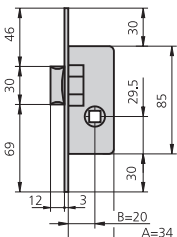
DESCRIPTION	REF. RÉF.	MEASUREMENTS DIMENSIONS		CAM CAME	FINISH FINITIONS		UNITS PIÈCES			
		B	A		FRONT PLATE TÊTIÈRE	CYLINDER CYLINDRE				
 <ul style="list-style-type: none"> <li>Lock with latch bolt only <i>Serrure avec demi-tour uniquement</i></li> <li>Without cylinder <i>Sans cylindre</i></li> </ul> <p><b>Strike plate options</b> <i>Options de gâche</i></p> <ul style="list-style-type: none"> <li>CE196R/6L</li> </ul>	1964R/0	20	34		HN		2	60		

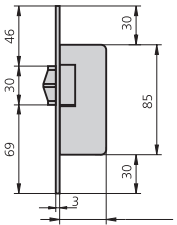
 <ul style="list-style-type: none"> <li>Lock with roller only <i>Serrure avec rouleau uniquement</i></li> <li>Without cylinder <i>Sans cylindre</i></li> </ul> <p><b>Strike plate options</b> <i>Options de gâche</i></p> <ul style="list-style-type: none"> <li>CE196R/6L</li> </ul>	1964RV/0		34		HN		2	60		
--	----------	--	----	--	----	--	---	----	--	--

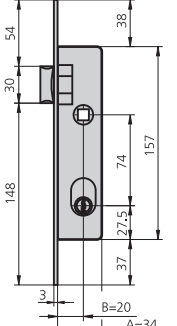
 <ul style="list-style-type: none"> <li>Lock with latch bolt only <i>Serrure avec pêne uniquement</i></li> <li>Cylinder 5964T25 <i>Cylindre 5964T25</i></li> </ul> <p><b>Electric strike plate option</b> <i>Option gâche électrique</i></p> <ul style="list-style-type: none"> <li>CELC196T/6A or / ou CELC196T/6AD</li> </ul>	1964T/0	20	34		HN	CN	1	20		
	1964T/5	20	34		HN	CL	1	20		
	1964T/6	20	34		Al	CN	1	20		

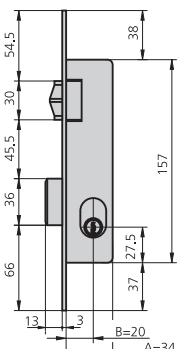
 <ul style="list-style-type: none"> <li>Adjustable roller and dead bolt <i>Rouleau réglable et pêne</i></li> <li>Cylinder 5964/2525 <i>Cylindre 5964/2525</i></li> </ul> <p><b>Strike plate options</b> <i>Options de gâche</i></p> <ul style="list-style-type: none"> <li>CE1984/0 or / ou CE1984/6</li> </ul>	1964V/0	20	34		HN	CN	1	20		
	1964V/5	20	34		HN	CL	1	20		
	1964V/6	20	34		Al	CN	1	20		

**LOCK WITH OVAL CYLINDER FOR DOORS WITH SKIRTING BOARD /  
SERRURE POUR PORTES À PLINTHES AVEC CYLINDRE OVALE À TIGES**

**1981 SERIES / SÉRIE 1981**

**CHARACTERISTICS /  
CARACTÉRISTIQUES**

**OPTIONAL ACCESSORIES /  
ACCESSOIRES OPTIONELS**

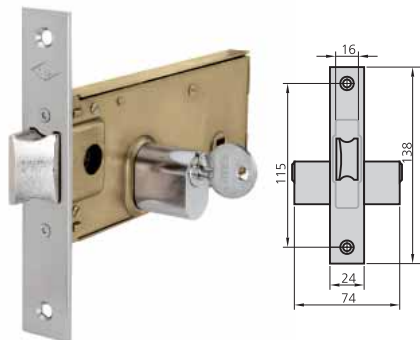

- Nickel plated iron front plate / Têtière en fer nickelé
- Bichromate treated sides / Boîtier bichromé
- Extensible and reversible latch bolt  
*Demi-tour extensible réversible*
- Extensible operated by key. Latch bolt operated by key and handle / Actionnement extensible avec clé. Actionnement du demi-tour avec clé et poignée
- 8mm square ruler / Carré de 8mm
- Monoblock oval cylinder (5081) o monoblock round cylinder (5181) / *Cylindre ovale monobloc (5081) ou cylindre rond monobloc (5181)*
- 2 nylon escutcheons ref. ES1964 or ES1962/4 / 2 plaques en nylon réf. ES1964 ou ES1962/4
- Cylinder set screw / Vis de fixation de cylindre
- Strike plate CE1991/0 / Gâche CE1991/0

- Cylinders / Cylindres  
(See below / voir ci-dessous 122)

DESCRIPTION	REF. RÉF.	MEASUREMENTS DIMENSIONS		CAM CAME	FINISH FINITIONS		UNITS PIÈCES			
		B	A		FRONT PLATE TÊTIÈRE	CYLINDER CYLINDRE				

OVAL CYLINDER /  
CYLINDRE OVALE

- Oval cylinder 5081/3030 / *Cylindre ovale 5081/3030*
- Strike plate CE1991/0 / Gâche CE1991/0
- Nylon escutcheon ES1964 / *Plaque en nylon ES1964*

1981/60/0	57	152		HN	CN	1	20		
1981/60/5	57	152		HN	CL	1	20		

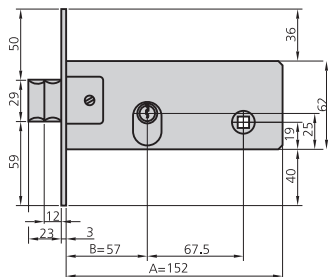

ROUND CYLINDER /  
CYLINDRE ROND

- Round cylinder 5181/3030 / *Cylindre rond 5181/3030*
- Strike plate CE1991/0 / Gâche CE1991/0
- Escutcheon ES1962/4 / *Plaque ES1962/4*

11981/60/0	57	152		HN	CN	1	20		
11981/60/5	57	152		HN	CL	1	20		

OVAL CYLINDER /  
CYLINDRE OVALE

- Extensible roller / *Rouleau extensible*
- Oval cylinder 5081/3030 / *Cylindre ovale 5081/3030*
- Strike plate CE1991/0 / Gâche CE1991/0
- Nylon escutcheon ES1964 / *Plaque en nylon ES1964*

1981V60/0	57	152		HN	CN	1	20		
1981V60/5	57	152		HN	CL	1	20		

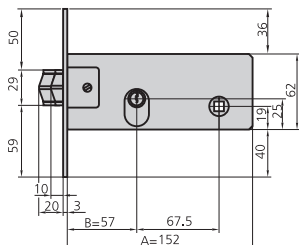

ROUND CYLINDER /  
CYLINDRE ROND

- Extensible roller / *Rouleau extensible*
- Round cylinder 5181/3030 / *Cylindre rond 5181/3030*
- Strike plate CE1991/0 / Gâche CE1991/0
- Escutcheon ES1962/4 / *Plaque ES1962/4*

11981V60/0	57	152		HN	CN	1	20		
11981V60/5	57	152		HN	CL	1	20		

**LOCK WITH DOUBLE CYLINDER FOR DOORS WITH SKIRTING BOARDS /  
SERRURE POUR PORTES À PLINTHES AVEC CYLINDRE EUROPROFIL**

**1991 SERIES / SÉRIE 1991**

**CHARACTERISTICS /  
CARACTÉRISTIQUES**

**OPTIONAL ACCESSORIES /  
ACCESSOIRES OPTIONELS**

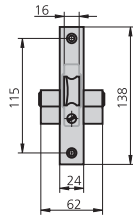

- Nickel plated iron front plate / *Têtière en fer nickelé*
- Bichromate treated sides / *Boîtier bichromé*
- Extensible and reversible latch bolt / *Demi-tour extensible et réversible*
- Extensible operated by key. Latch bolt operated by key and handle / *Actionnement extensible avec clé. Actionnement du demi-tour avec clé et poignée*
- 8mm square ruler / *Carré de 8mm*
- Double european profile cylinder / *Cylindre europrofil*
- 2 nylon escutcheons ref. ES1984 / *2 plaques en nylon réf. ES1984*
- Cylinder set screw / *Vis de fixation de cylindre*
- Strike plate CE1991/0 / *Gâche CE1991/0*

- Complete range of cylinders / *Gamme complète de cylindres*  
(See page / voir page 111-120)

DESCRIPTION	REF. RÉF.	MEASUREMENTS DIMENSIONS		CAM CAME	FINISH FINITIONS		UNITS PIÈCES			
		B	A		FRONT PLATE TÊTIÈRE	CYLINDER CYLINDRE				
• Extensible and reversible latch bolt <i>Demi-tour extensible et réversible</i>	1991/60/0	58	149	15	HN	CN	1	20		
• Double european profile cylinder. 5982/2525 <i>Cylindre europrofil 5982/2525</i>	1991/60/5	58	149	15	HN	CL	1	20		
• Strike plate CE1991/0 <i>Gâche CE1991/0</i>	1991/70/0	68	159	15	HN	CN	1	20		
	1991/70/5	68	159	15	HN	CL	1	20		

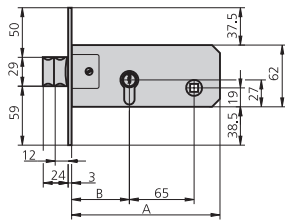

**LOCK WITH HOOK ONLY WITH OVAL CYLINDER /  
SERRURE À CROCHET UNIQUEMENT AVEC CYLINDRE OVALE À TIGES**

**1968 SERIES / SÉRIE 1968**

**CHARACTERISTICS /  
CARACTÉRISTIQUES**

**OPTIONAL ACCESSORIES /  
ACCESSOIRES OPTIONELS**

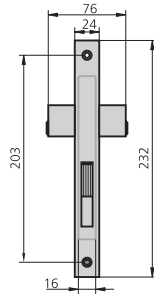

- Nickel plated iron front plate  
*Têtière en fer nickelé*
- Bichromate treated sides  
*Boîtier bichromé*
- Hook dead bolt  
*Pêne à crochet*
- Monoblock oval cylinder (5968)  
*Cylindre ovale monobloc*
- 2 nylon escutcheons ref. ES1964  
*2 plaques en nylon réf ES1964*
- Cylinder set screw  
*Vis de fixation de cylindre*

DESCRIPTION	REF. REF.	MEASUREMENTS DIMENSIONS		CAM CAME	FINISH FINITIONS		UNITS PIÈCES			
		B	A		FRONT PLATE TÊTIÈRE	CYLINDER CYLINDRE				
<ul style="list-style-type: none"> <li>• Lock with tilting hook dead bolt <i>Serrure avec pêne basculant à crochet</i></li> <li>• Cylinder 5968/2525 <i>Cylindre 5968/2525</i></li> </ul>	1968/0	17	34		HN	CN	1	20		
	1968/5	17	34		HN	CL	1	20		

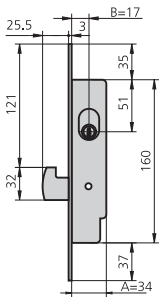

**LOCK WITH HOOK ONLY WITH EUROPEAN PROFILE CYLINDER /  
SERRURE À CROCHET UNIQUEMENT AVEC CYLINDRE OVALE À TIGES**

**1982 SERIES / SÉRIE 1982**

**CHARACTERISTICS /  
CARACTÉRISTIQUES**

**OPTIONAL ACCESSORIES /  
ACCESSOIRES OPTIONELS**

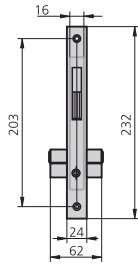

- Nickel plated iron front plate  
*Têtière en fer nickelé*
- Bichromate treated sides  
*Boîtier bichromé*
- Hook dead bolt / *Pêne à crochet*
- Double european profile cylinder  
*Cylindre europrofil*
- 2 nylon escutcheons ref. ES1984  
*2 plaques en nylon réf ES1984*
- Cylinder set screw  
*Vis de fixation de cylindre*

DESCRIPTION	REF. RÉF.	MEASUREMENTS DIMENSIONS		CAM CAME	FINISH FINITIONS		UNITS PIÈCES			
		B	A		FRONT PLATE TÊTIÈRE	CYLINDER CYLINDRE				
<ul style="list-style-type: none"> <li>• Lock with tilting hook dead bolt <i>Serrure avec pêne basculant à crochet</i></li> <li>• Cylinder 5982/2525 <i>Cylindre 5982/2525</i></li> </ul>	1982/0	17	34		HN	CN	1	20		
	1982/5	17	34		HN	CL	1	20		

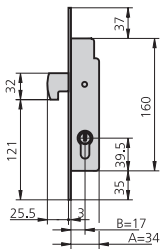

**CHARACTERISTICS /  
CARACTÉRISTIQUES**

**OPTIONAL ACCESSORIES /  
ACCESSOIRES OPTIONELS**

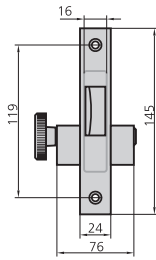

- Nickel plated iron front plate  
*Têtière en fer nickelé*
- Bichromate treated sides / *Boîtier bichromé*
- Reversible latch bolt operated by key from outside and by knob from inside or operated by key from both sides  
*Demi-tour réversible actionné par une clé à l'extérieur et avec bouton à l'intérieur ou actionnement avec clé des 2 côtés*
- Monoblock oval cylinder (5979)  
*Cylindre ovale monobloc*
- 2 nylon escutcheons ref. ES1964  
*2 plaques en nylon réf ES1964*
- Cylinder set screw  
*Vis de fixation de cylindre*

METAL WORK  
MENUISERIE MÉTALLIQUE

DESCRIPTION	REF. RÉF.	MEASUREMENTS DIMENSIONS		CAM CAME	FINISH FINITIONS		UNITS PIÈCES			
		B	A		FRONT PLATE TÊTIÈRE	CYLINDER CYLINDRE				

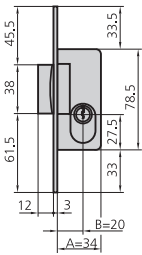

- Reversible latch bolt operated by key from outside and by knob from inside  
*Demi-tour réversible actionné par clé à l'extérieur et bouton à l'intérieur*
- 5979P3030

1979P/0	20	34	HN	CN	1	30		
1979P/5	20	34	HN	CL	1	30		

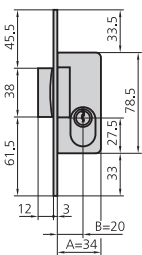

- Reversible latch bolt operated by key from outside and inside  
*Demi-tour réversible actionné avec clé à l'extérieur et à l'intérieur*
- 5979/3030

1979/0	20	34	HN	CN	1	30		
1979/5	20	34	HN	CL	1	30		

**LOCK FOR METAL ROLL-UP DOORS AND PERSIAN BLINDS /  
SERRURE POUR PORTES ET PERSIENNES MÉTALLIQUES ENROULABLES**

**11A SERIES / SÉRIE 11A**

**CHARACTERISTICS /  
CARACTÉRISTIQUES**

**OPTIONAL ACCESSORIES /  
ACCESSOIRES OPTIONELS**



- Lock for metal roll-up doors  
*Serrure pour portes métalliques enroulables*
- Operated by key from outside and inside  
*Actionnement extérieur et intérieur par clé*
- Bichromate treated sides  
*Boîtier bichromé*
- Round cylinder with 3 pins  
*Cylindre rond à 3 goupilles*

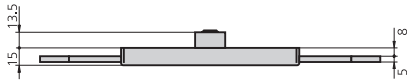

DESCRIPTION	REF. REF.	MEASUREMENTS DIMENSIONS		CAM CAME	FINISH FINITIONS		UNITS PIÈCES	
		B	A		FRONT PLATE TÊTIÈRE	CYLINDER CYLINDRE		
<ul style="list-style-type: none"> <li>• Two lateral locking points <i>Deux points horizontaux de fermeture</i></li> </ul>	11A	60	154		CL		1	24

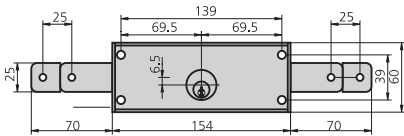

<ul style="list-style-type: none"> <li>• Two lateral locking points and one bottom locking point <i>Deux points horizontaux de fermeture et</i></li> </ul>	11A/3P	60	154		CL		1	
--	--------	----	-----	--	----	--	---	--

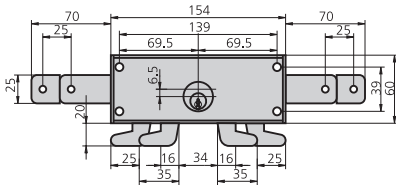

**LOCK FOR METAL ROLL-UP DOORS AND PERSIAN BLINDS /  
SERRURE POUR PORTES ET PERSIENNES MÉTALLIQUES ENROULABLES**

**11E SERIES / SÉRIE 11E**

**CHARACTERISTICS /  
CARACTÉRISTIQUES**

**OPTIONAL ACCESSORIES /  
ACCESSOIRES OPTIONELS**



- Lock for metal roll-up persian blind  
*Serrure pour persiennes métallique enroulable*
- Operated by key from outside and inside  
*Actionnement extérieur et intérieur par clé*
- Round cylinder with 3 pins  
*Cylindre rond à 3 goupilles*

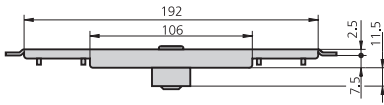

**DESCRIPTION**

REF.  
REF.

MEASUREMENTS  
DIMENSIONS

CAM  
CAME

FINISH  
FINITIONS

UNITS  
PIÈCES

B

A

FRONT PLATE CYLINDER  
TÊTIÈRE CYLINDRE



- Two horizontal locking points  
*Deux points de fermeture horizontaux*

11E	30	216		CL	1	20		
-----	----	-----	--	----	---	----	--	--

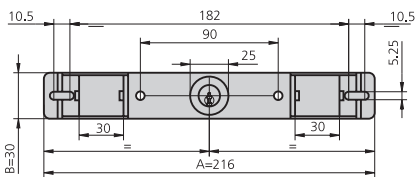

**LOCK FOR HINGED METAL DOORS /  
SERRURE POUR PORTES MÉTALLIQUES BASCULANTES**

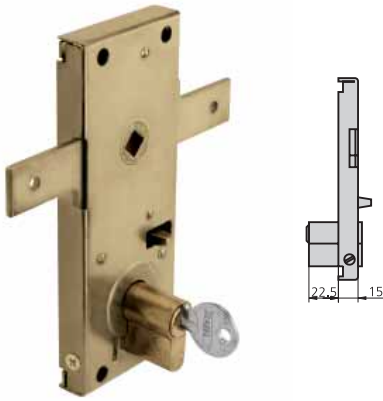

**11B SERIES / SÉRIE 11B**



**CHARACTERISTICS /  
CARACTÉRISTIQUES**

- Operated by handle / Actionnement par poignée
- It is locked with the knob from the inside and by key from the outside  
*Verrouillage intérieur par bouton  
verrouillage extérieur par clé*
- Two horizontal locking points  
*2 points de fermeture horizontaux*
- Bichromate treated sides / Boîtier bichromé
- Single european profile cylinder ref. 5982T40/3  
*Moyen cylindre monobloc Réf 5982T40/3*
- Optionally comes with escutcheon and handles set (ref. 11B/M) / Optionnellement avec set de plaque et poignées (réf. 11B/M)
- 1 escutcheon ref. ES1960 / 1 plaque réf ES1960

**OPTIONAL ACCESSORIES /  
ACCESSOIRES OPTIONELS**

DESCRIPTION	REF. RÉF.	MEASUREMENTS DIMENSIONS		CAM CAME	FINISH FINITIONS		UNITS PIÈCES			
		B	A		FRONT PLATE TÊTIÈRE	CYLINDER CYLINDRE				
<ul style="list-style-type: none"> <li>• Two horizontal locking points <i>Deux points de fermeture horizontaux</i></li> </ul>	11B	60	154	15		CL	1	40		
<ul style="list-style-type: none"> <li>• Single european profile cylinder 5982T40/3 <i>Demi cylindre monoblock 5982T40/3</i></li> </ul>	11B/M	60	154	15		CL	1	40		

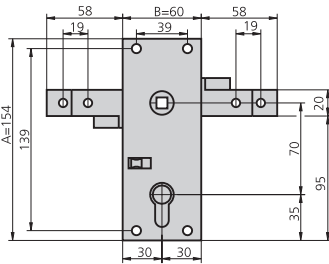

**ACCESSORIES / ACCESSOIRES**

**STRIKE PLATES FOR METAL LOCKS / GÂCHES POUR SERRURES MÉTALLIQUES**

DESCRIPTION	REF. RÉF.	FINISH FINITION	APPLIES TO LOCKS APPLICABLE A SERRURES	UNITS PIÈCES
-------------	--------------	--------------------	---	-----------------

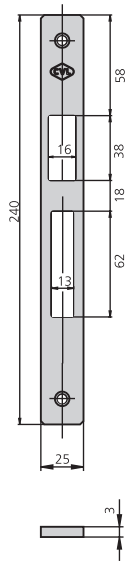

CE1983/0	HN	1983		
CE1983/6	Al			

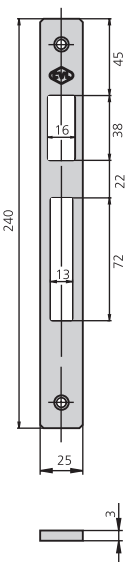

CE1984/0	HN	1984, 1992, 1995,		
CE1984/6	Al	1964, 1963, 1975		

CE1984

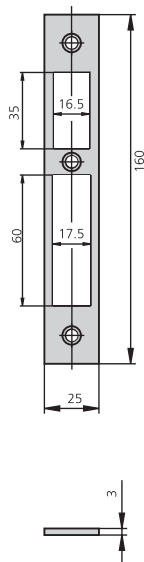

CE1990/0	HN	1990		
----------	----	------	--	--

CE1990



DESCRIPTION	REF. RÉF.	FINISH FINITION	APPLIES TO LOCKS APPLICABLE A SERRURES	UNITS PIÈCES
-------------	--------------	--------------------	---	-----------------

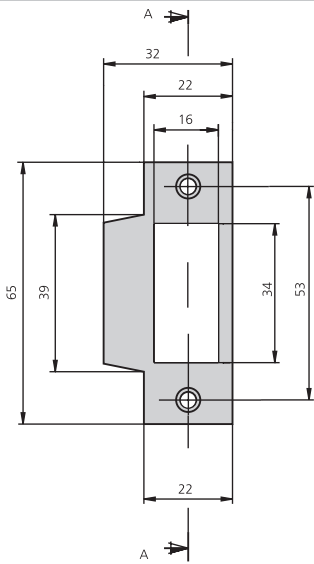

CE1991/0      HN      1991, 1981, 11981



CE1994/6      Al      1994, 2994

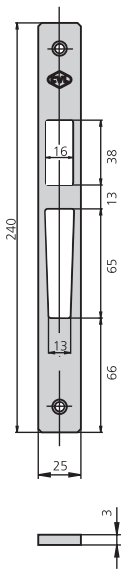

CE2994S/6      Al      1983A, 1963A, 1975A,  
1995A, alto/bajo 2994

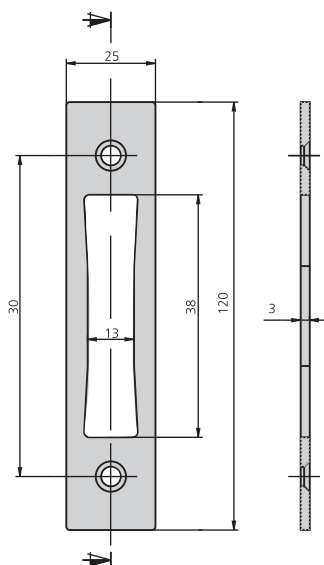

DESCRIPTION	REF. RÉF.	FINISH FINITION	APPLIES TO LOCKS APPLICABLE A SERRURES	UNITS PIÈCES
-------------	--------------	--------------------	---	-----------------

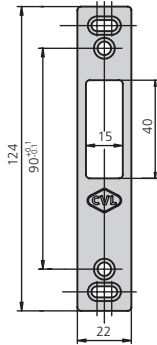

CE196R/6





Al

1963R, 1964R, 1983R,  
1995R



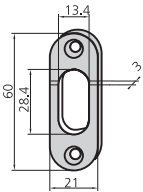

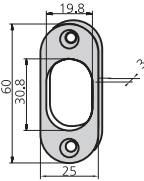

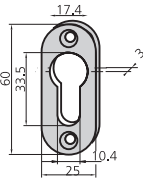
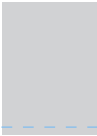
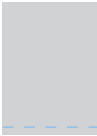

ACCESSORIES / ACCESSOIRES

ESCUTCHEONS / PLAQUES

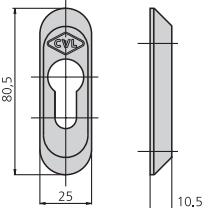
DESCRIPTION	REF. RÉF.	FINISH FINITION	APPLIES TO LOCKS APPLICABLE A SERRURES	UNITS PIÈCES
	ES1963	Nylon escutcheon / Plaque en nylon	1963, 1975	 
	ES1964	Nylon escutcheon / Plaque en nylon	1964, 1968, 1979, 1981	 
	ES1984	Nylon escutcheon / Plaque en nylon	1982, 1983, 1984, 1990, 1992, 1994, 1995, 196, 184, 183, 192, 194, 194, P194	 

ACCESSORIES / ACCESSOIRES

SECURITY ESCUTCHEONS / PLAQUES DE SECURITÉ

DESCRIPTION	REF. RÉF.	FINISH FINITION	APPLIES TO LOCKS APPLICABLE A SERRURES	UNITS PIÈCES
	BT194/1N	BLACK/ NOIRE	1983, 1984, 1990,	 
	BT194/1NM	MATT NICKEL / NICKEL MAT	1992, 1994, 1995,	
	BT194/1PL	SILVER/ARGENT	2994, 183, 184, 192	
		  	<p>BLACK NOIRE</p> <p>MATT NICKEL NICKEL MAT</p> <p>SILVER ARGENT</p>	